

Dimensions in mm						No of Inserts	Insert Designation
ØD1	ØD2	L1	L2	R	Max ap		
12	16	70	20	0.4	7	1	XDHT 090308
14	16	70	20	0.4	7	1	
16	20	80	30	0.4	9	1	
18	20	80	30	0.4	9	1	
20	20	80	30	0.4	12	2	XPHT 160408
22	25	85	30	0.4	12	2	
24	25	85	30	0.4	12	2	
26	32	95	35	0.4	12	2	
30	32	95	40	0.8	15	2	
35	32	95	40	0.8	15	2	

Insert	Insert Screw	Torx key
XDHT 090308	2.5	T 8
XPHT 160408	3.5	T 15

Note: We can suit ISO insert any make like SANDVIK, SECO, WIDIA, KORLOY, MITSUBISHI, ISCAR, TAEGUTEC, PLANSEE TIZIT, KYOCERA etc.,

**MTS SQ. SHOULDER AND SLOT MILLING CUTTER - SPL**

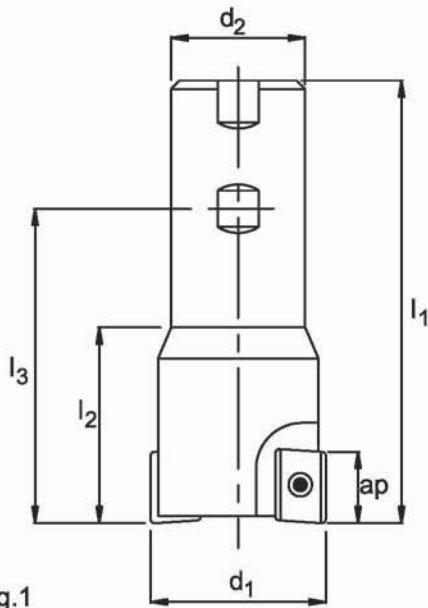

Fig.1

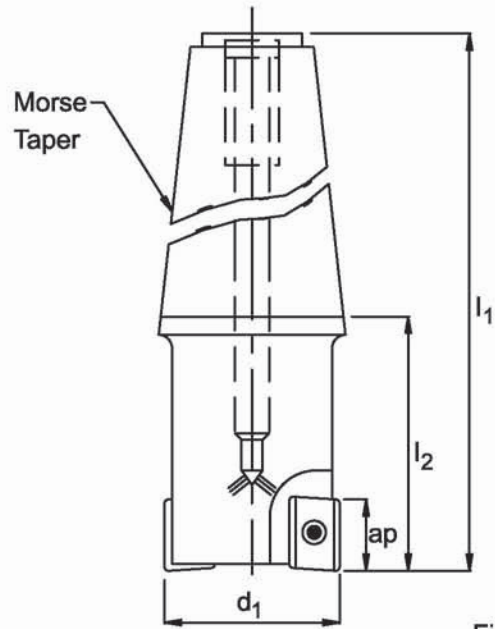

Fig.2

Dimensions in mm						No of inserts	Insert Ord.No.
Ød1	Ød2	l1	l2	l3	Max ap		
16	16	70	25	51	8	2	XDHT 09 03..
20	20	80	30	57	8	2	
25	25	90	40	64	8	2	
32	32	100	40	64	8	4	
40	32	100	50	74	8	4	
25	25	90	40	64	14	2	XPHT 16 04..
32	32	100	40	64	14	3	
40	32	100	50	74	14	4	

Ød1	l1	l2	Max ap	Morse Taper	No of inserts	Insert Ord.No.
16	95	30	8	2	2	XDHT 09 03..
20	110	30	8	3	2	
25	125	40	8	3	2	
32	125	50	8	3	4	
40	150	40	8	4	4	
25	125	40	14	3	2	XPHT 16 04..
32	125	40	14	3	2	
40	150	50	14	4	4	

Insert	Insert Screw	Torx key
XDHT 09 03..	2.5	T 8
XPHT 16 04..	3.5	T 15

Note: We can suit ISO insert any make like SANDVIK, SECO, WIDIA, KORLOY, MITSUBISHI, ISCAR, TAEGUTEC, PLANSEE TIZIT, KYOCERA etc.,

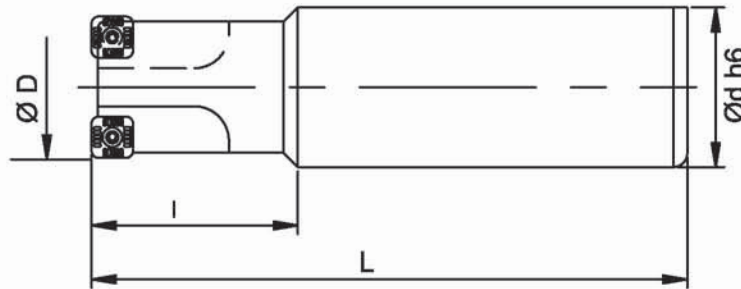

Entering Angle: 90°

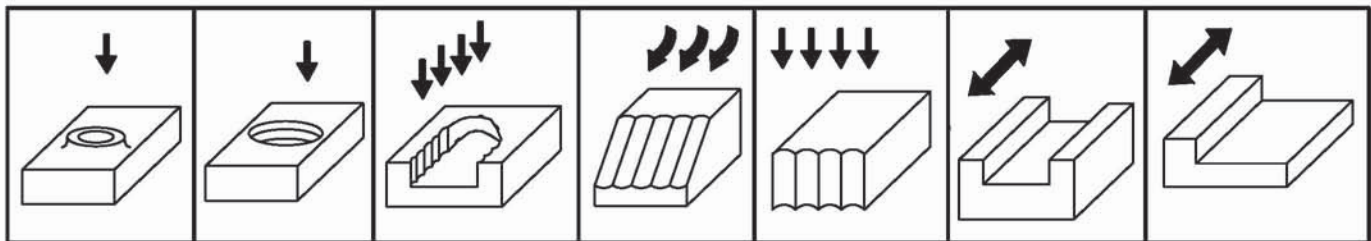

Designation	Insert	No. of Inserts	Dimensions(mm)				Max. Drilling depth, Cd	End Milling depth, ap
			D	l	d	L		
SF-216-S20-06	SOMT 060204	2	16	30	20	90	18	5.6
SF-320-S20-06		3	20					
SF-222-S25-09	SCMT 09T308	2	22	50	25	100	28	9
SF-225-S25-09	SPMT 09T308		25					
SF-332-S32-12	SCMT 120408	3	32	50	32	115	39	10.7
SF-440-S32-12	SPMT 120408	3	40					
SF-445-S32-16	TCMT 16T308	3	45	60	32	130	50	-
SF-450-S32-16			50					

**Spare Parts**

Insert	Insert Screw	Torx Key
SOMT 060204	2.5	T 8
SCMT 09T308	3.5	T 15
SCMT 120408	4.5	T 20
TCMT 16T308	3.5	T 15

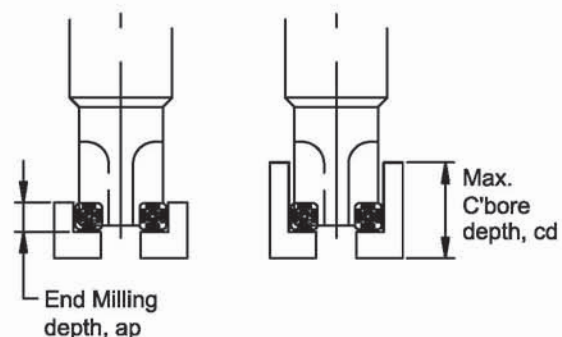

Note: We can suit ISO insert any make like SANDVIK, SECO, WIDIA, KORLOY, MITSUBISHI, ISCAR, TAEGUTEC, PLANSEE TIZIT, KYOCERA etc.,

**SLOTTING, SHOULDERING, RAMPING AND CONTOURING - SPL**

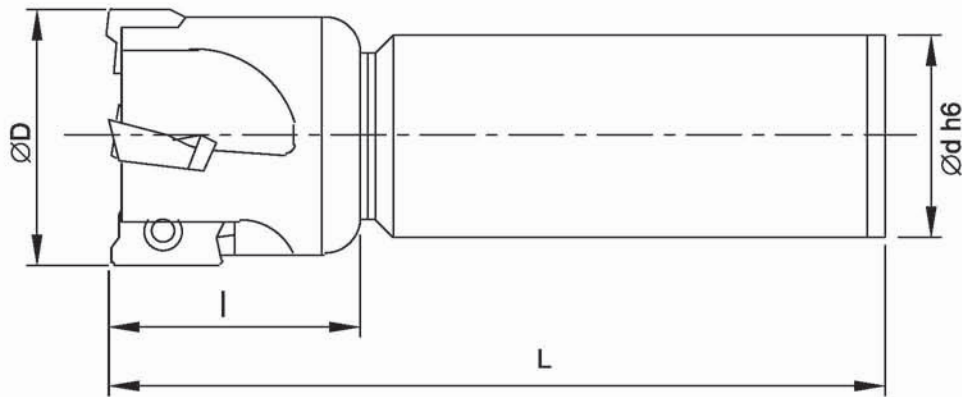

Entering Angle: 90°

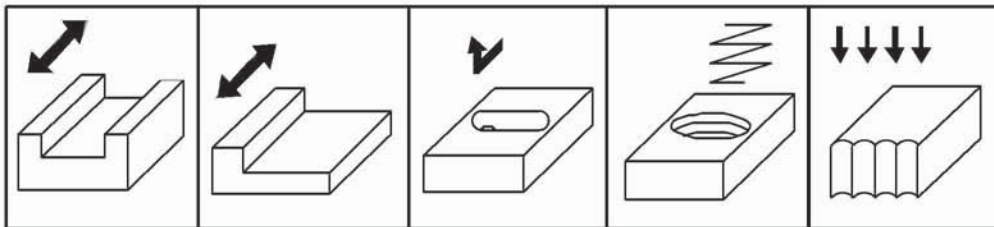

Designation	Insert	No. of Inserts	Dimension(mm)			
			D	d	L	l
SM90-120-S20-17	APKT 1705 PER-M APKT 1705 PER-EM APKT 1705 R-EM APKT 1705 PER-AL	1	20	20	90	30
SM90-225-S25-17		2	25	25	100	35
SM90-225-S25-17					210	40
SM90-232-S32-17		3	32	32	250	50
SM90-332-S32-17					110	40
SM90-332-S32-17					200	50
SM90-240-S32-17		2	40	32	250	55
SM90-340-S32-17		3			200	

Screw	Tory Key
3.5	T 15

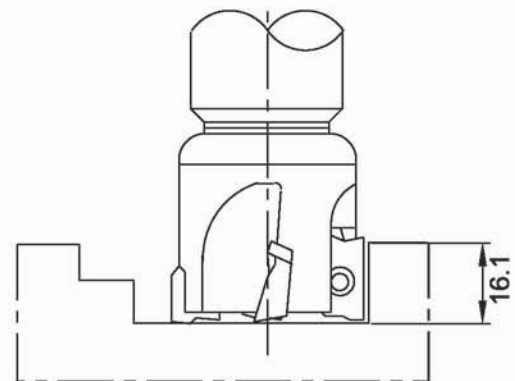



**SLOTTING, SHOULDERING, RAMPING AND CONTOURING - SPL**

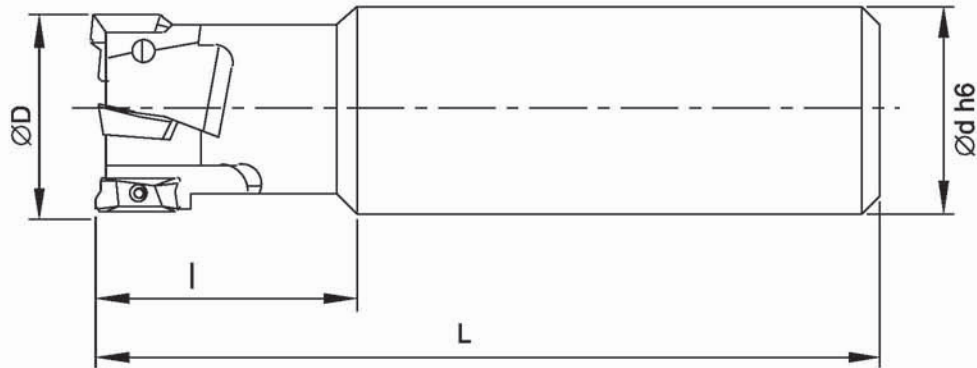

Entering Angle: 90°.

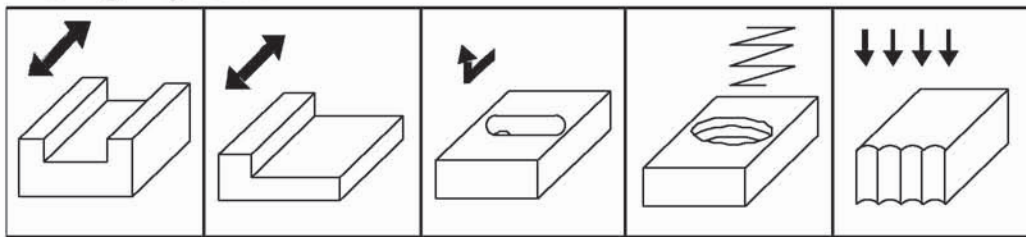

Designation	Insert	No.of Inserts	Dimension(mm)				
			D	d	L	l	
SM90-216-S16-09	ADKT 0903 PER-ML ADKT 0903 PER-EML ADKT 090308R-EML ADKT 090316R-EML ADKT 0903 PER-AL	2	16	16	90	30	
SM90-216-S16-09			145				
SM90-218-S16-09		18	20	90			
SM90-220-S20-09		170					
SM90-320-S20-09		3	20	110	40		
SM90-322-S20-09				22	210		30
SM90-225-S20-09		2	25	110			
SM90-325-S20-09		3	25	110			
SM90-232-S25-09		2	32	25	250		32
SM90-240S32-09		2	40	32	250		

Screw	Torx Key
Ø 2.5 X 0.45	T8

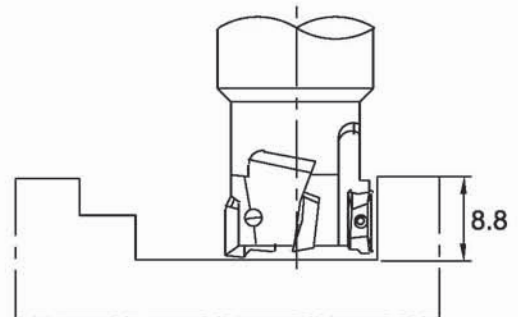

Note: We can suit ISO insert any make like SANDVIK, SECO, WIDIA, KORLOY, MITSUBISHI, ISCAR, TAEGUTEC, PLANSEE TIZIT, KYOCERA etc.,

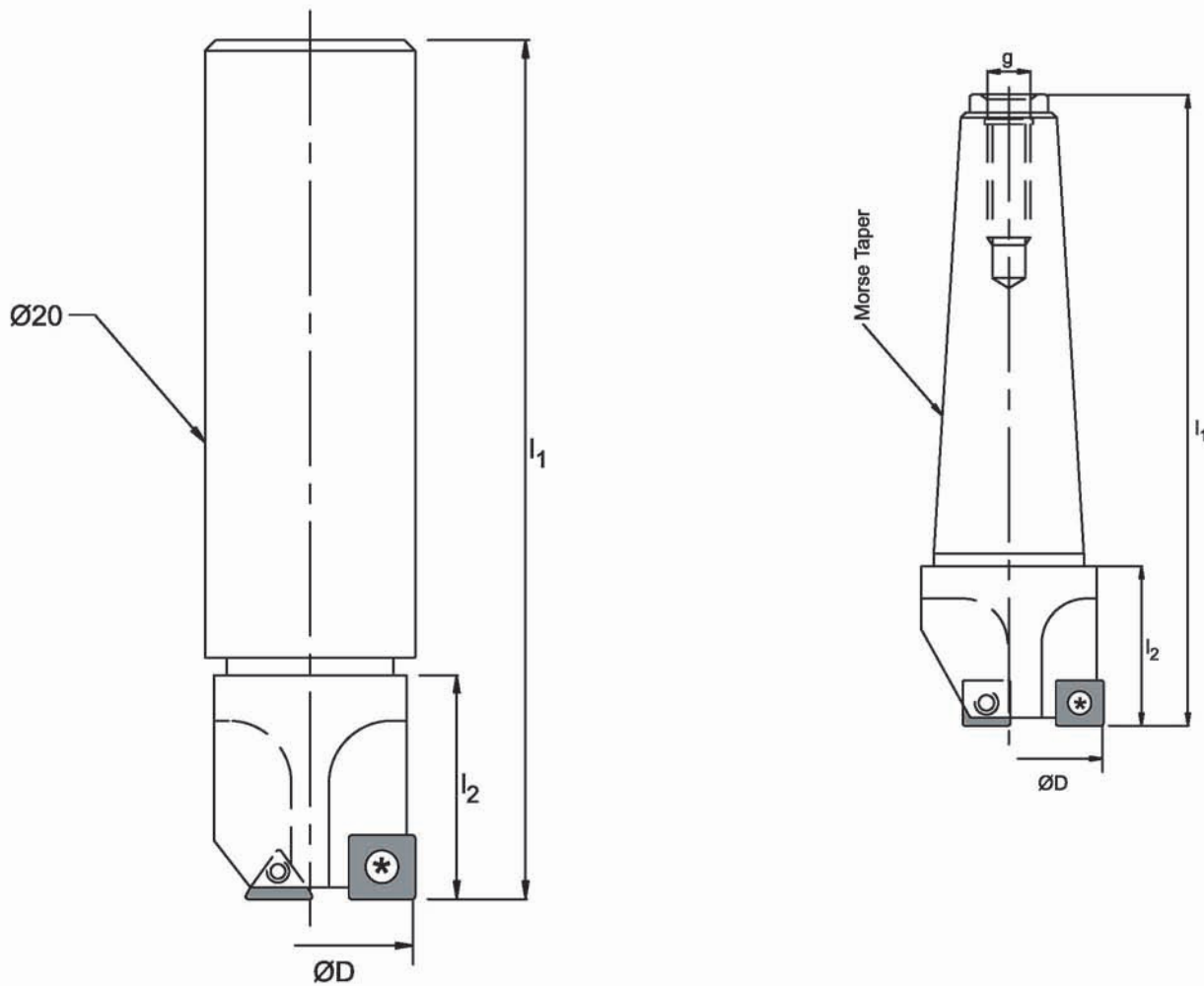

Dimensions in mm				Morse Taper	No. of inserts	ISO insert designation
D	l1	l2	g			
25	125	32	M 12	3	1 1	TCMT 11 02 04 SCMT 09 T3 08
32	125	32	M 12	3	2	SCMT 09 T3 08
40	150	32	M 16	4	2	SCMT 12 04 08
50	150	32	M 16	4	2	SCMT 19 04 12

**SPARE PARTS**

ISO Insert	Insert screw	ISO Torx driver	Allen Key
TCMT 11 02 04	2.5	T 8	-
SCMT 09 T3 08	3.5	T 15	-
SCMT 12 04 08	4.5	T 20	-
SCMT 19 04 12	5.0	-	4 mm

Note: We can suit ISO insert any make like SANDVIK, SECO, WIDIA, KORLOY, MITSUBISHI, ISCAR, TAEGUTEC, PLANSEE TIZIT, KYOCERA etc.,

# FRONT AND BACK CHAMFERING CUTTER

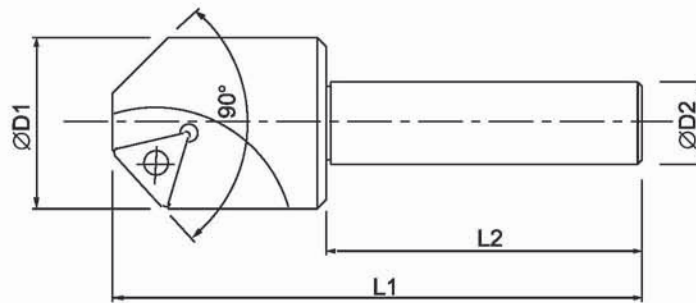

ORDER NO.	ØD1	ØD2	L1	L2	Inserts
C25-ST20-90°	25	20	95	60	TCMT 110204
C32-ST25-90°	32	25			
C40-ST25-90°	32				TCMT 16T308
C50-ST12-90°	50	32			

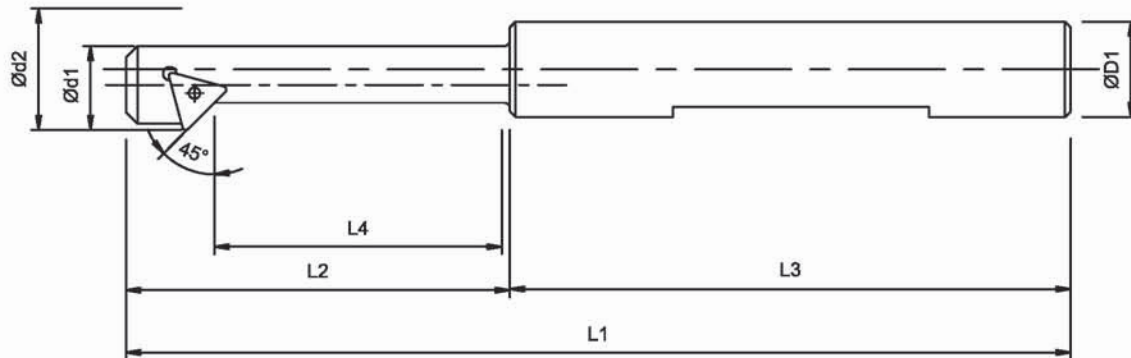

Ød1	Ød2	ØD1	L1	L2	L3	L4	Inserts
7.5	9.5	12	109	39	70	32	TCMT 06T104
8.5	11.5		119	49		42	
10	14	16	131	61		52	TCMT 090204
12	16		136	66		57	
14	18.5	20	142	72		62	TCMT 110204
16	20.5		152	82		72	
21	27	25	152	82		72	
24	31		152	82		72	

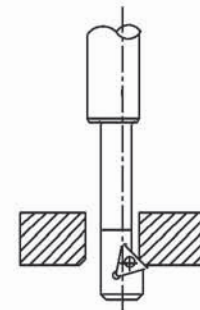

## Spare Parts

Insert	Clamping screw	Torx key
TCMT 06T104	2.0	T 6
TCMT 090204	2.2	T 7
TCMT 110204	2.5	T 8
TCMT 16T308	3.5	T 15

Note: Specials on request

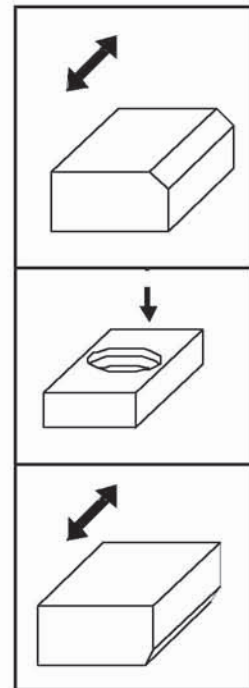
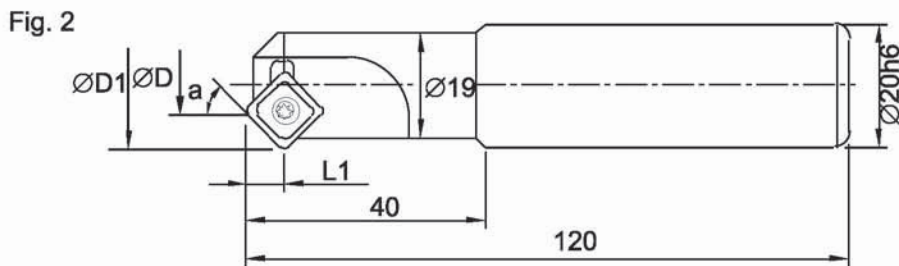
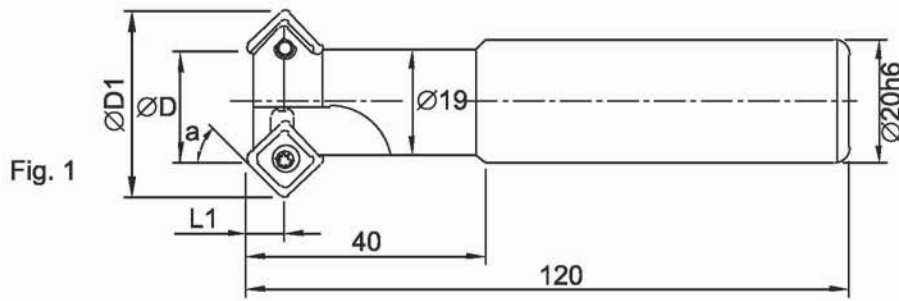

Designation	Insert	No. of inserts	Dimensions				Fig	Application Range
			a	D	D1	L1		
CF15-D26-09	SCMT 09T308	2	15°	25	30	8.35	1	26-30
CF30-D27-09		2	30°	26	35	7.25	1	27-34
CF45-D07-12	SCMT 120408	1	45°	6	22	8.15	2	8.0-20
CF45-D19-12		2	45°	18.5	35	8.15	1	20-33
CF45-D25-12		2	45°	23.5	40	8.15		25-38

**Spare Parts**

Insert	Clamping screw	Torx key
SCMT 09T308	3.5	T15
SCMT 120408	4.5	T20

