



**STANNY** IMP

SACC Cutting Insert Holder



SBCC Cutting Insert Holder

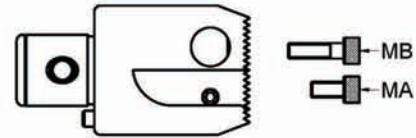
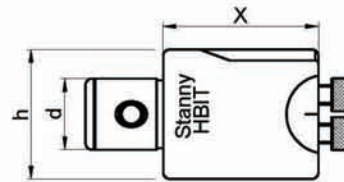

Body for H•BIT Adjustable Twin Cutter Roughing

Model	Øh	Ød	X	MA Bolt	MB Bolt	N.W.
HBIT25	25	14	40	M4x10	M4x18	0.15
HBIT32	32	18	50	M5x10	M5x20	0.33
HBIT40	40	22	48	M6x12	M6x20	0.48
HBIT50	50	28	62	M6x14	M6x25	0.96
HBIT63	63	36	58	M8x16	M8x30	1.54
HBIT80	80	36	58			1.96

Cutting Insert Holder for H•BIT Adjustable Twin Cutter Roughing

Cutting Insert Holder	System	Boring Range ØDmin ~ ØDmax	W	e	Insert	ap	Bolt	Wrench	N.W.
SACC2936	HBIT25	29 ~ 36	12	25	CCMT0602..	0.5 - 1	M2.5	T8	0.01
SACC3542		35 ~ 42		30		1 - 3			
SACC3645	HBIT32	36 ~ 45	16	32	CCMT09T3..		0.5 - 1	M4	T15
SACC4453		44 ~ 53		38		1 - 4			
SACC4556	HBIT40	45 ~ 56	18	40	CCMT1204..		0.5 - 1	M5	T25
SACC5566		55 ~ 66		46.5		1 - 5			
SACC5674	HBIT50	56 ~ 74	23	48.5	CCMT1204..		0.5 - 1	M5	T25
SACC7492		74 ~ 92		62		1 - 5			
SACC7090	HBIT63	70 ~ 90	23	60	CCMT1204..		0.5 - 1	M5	T25
SACC90110		90 ~ 110		78		1 - 5			
SACC90130	HBIT80	90 ~ 130	23	79.5	CCMT1204..		0.5 - 1	M5	T25
SACC130170		130 ~ 170		99.5		1 - 5			



Cutting Insert Holder for H•BIT Adjustable Twin Cutter Roughing

Cutting Insert Holder	System	Boring Range ØDmin ~ ØDmax	W	e	Insert	ap	Bolt	Wrench	N.W.
SBCC2936	HBIT25	29 ~ 36	11.7	25	CCMT0602..	0.5 - 1	M2.5	T8	0.01
SBCC3542		35 ~ 42		30					
SBCC3645	HBIT32	36 ~ 45	15.6	32	CCMT09T3..	0.5 - 1	M4	T15	0.02
SBCC4453		44 ~ 53		38					
SBCC4556	HBIT40	45 ~ 56	17.6	40	CCMT1204..	0.5 - 1	M5	T25	0.04
SBCC5566		55 ~ 66		46.5					
SBCC5674	HBIT50	56 ~ 74	22.6	48.5	CCMT1204..	0.5 - 1	M5	T25	0.05
SBCC7492		74 ~ 92		62					
SBCC7090	HBIT63	70 ~ 90	22.6	60	CCMT1204..	0.5 - 1	M5	T25	0.07
SBCC90110		90 ~ 110		78					
SBCC90130	HBIT80	90 ~ 130	22.6	79.5	CCMT1204..	0.5 - 1	M5	T25	0.09
SBCC130170		130 ~ 170		99.5					



**H-BIT Adjustable Twin Cutter Roughing and Semi-Finishing Boring System**

**STANNY** IMP

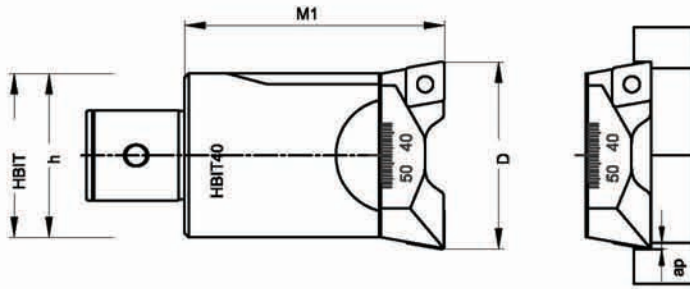

SACC and SACC Cutting Insert Holders have the same Cutting Diameter and Height

Model	Boring Range ØDmin ~ Ødmax	M1	h	Boring Head	Cutting Insert Holder	N.W.
HBIT25	AA 29 ~ 36	50	25	HBIT25	SACC2936	0.17
HBIT25	AA 35 ~ 42				SACC3542	0.19
HBIT32	AA 36 ~ 45	63	32	HBIT32	SACC3645	0.37
HBIT32	AA 44 ~ 53				SACC4453	
HBIT40	AA 45 ~ 56	63	40	HBIT40	SACC4556	0.56
HBIT40	AA 55 ~ 66				SACC5566	0.58
HBIT50	AA 56 ~ 74	80	50	HBIT50	SACC5674	1.10
HBIT50	AA 74 ~ 92				SACC7492	1.14
HBIT63	AA 70 ~ 90	80	63	HBIT63	SACC7090	1.78
HBIT63	AA 90 ~ 110				SACC90110	1.90
HBIT80	AA 90 ~ 130	80	63	HBIT80	SACC90130	2.30
HBIT80	AA 130 ~ 170				SACC130170	2.44

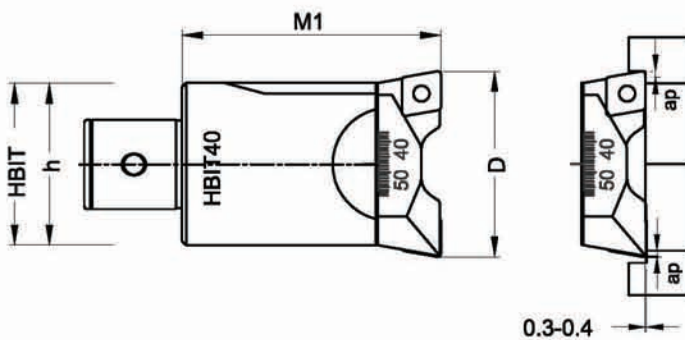

SACC and SBCC Cutting Insert Holders have different Cutting Diameter and Height

Model	Boring Range ØDmin ~ Ødmax	M1	h	Boring Head	Cutting Insert Holder	N.W.
HBIT25	AB 29 ~ 36	50	25	HBIT25	SACC2936	0.17
HBIT25	AB 35 ~ 42				SACC3542	0.19
HBIT32	AB 36 ~ 45	63	32	HBIT32	SACC3645	0.37
HBIT32	AB 44 ~ 53				SACC4453	
HBIT40	AB 45 ~ 56	63	40	HBIT40	SACC4556	0.56
HBIT40	AB 55 ~ 66				SACC5566	0.58
HBIT50	AB 56 ~ 74	80	50	HBIT50	SACC5674	1.10
HBIT50	AB 74 ~ 92				SACC7492	1.14
HBIT63	AB 70 ~ 90	80	63	HBIT63	SACC7090	1.78
HBIT63	AB 90 ~ 110				SACC90110	1.90
HBIT80	AB 90 ~ 130	80	63	HBIT80	SACC90130	2.30
HBIT80	AB 130 ~ 170				SACC130170	2.44

**Reverse Cutting Insert Holder for H.BIT Adjustable Single Cutter Roughing**

Reverse Cutting Insert Holder	System	Boring Range ØDmin ~ ØDmax	Apron	aw	wk	e	Insert	ap	Bolt	Wrench	N.W.				
RKCC2936	HBIT25	29 ~ 36	apr25	4	11	25	CCMT0602..	0.5 - 3	M2.5	T8	0.01				
RKCC3542		35 ~ 42		7		30					0.02				
RKCC3645	HBIT32	36 ~ 45	apr32	5		32					0.02				
RKCC4453		44 ~ 53		9	38	-TS25									
RKCC4556	HBIT40	45 ~ 56	apr40	7	15	40	CCMT09T3..	0.5 - 4	M4	T15	0.04				
RKCC5566		55 ~ 66		10		46.5					0.05				
RKCC5674	HBIT50	56 ~ 74	apr50	11		17					48.5	CCMT1204..	0.5 - 5	-TS4	T15
RKCC7492		74 ~ 92		17	62						0.09				
RKCC7090	HBIT63	70 ~ 90	apr63	12	22		60	CCMT1204..	0.5 - 5	M5	T25				
RKCC90110		90 ~ 110		22		78	0.18								
RKCC90130	HBIT80	90 ~ 130	apr80	24		22	79.5					CCMT1204..	0.5 - 5	-TS5	T25
RKCC130170		130 ~ 170		44	99.5		0.25								



**RKCC Reverse Cutting Insert Holder**

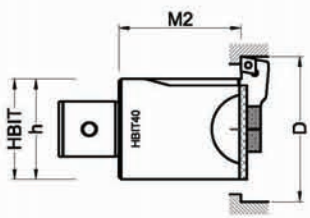
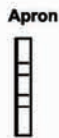
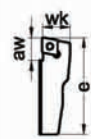
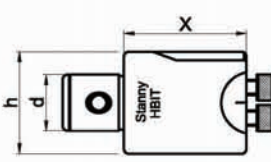

Model	System	N.W.
apr25	HBIT25	0.01
apr32	HBIT32	0.01
apr40	HBIT40	0.02
apr50	HBIT50	0.04
apr63	HBIT63	0.07
apr80	HBIT80	0.09



**Reverse Cutting Insert Holder for H.BIT Adjustable Single Cutter Roughing**

Model	Boring Range ØDmin ~ ØDmax	M1	h	Boring Head	Reverse Cutting Insert Holder	Apron	N.W.
HBIT25 AK	29 ~ 36	40	25	HBIT25	RKCC2936	apr25	0.17
HBIT25 AK	35 ~ 42				RKCC3542		0.18
HBIT32 AK	36 ~ 45	50	32	HBIT32	RKCC3645	apr32	0.36
HBIT32 AK	44 ~ 53				RKCC4453		
HBIT40 AK	45 ~ 56	48	40	HBIT40	RKCC4556	apr40	0.54
HBIT40 AK	55 ~ 66				RKCC5566		0.55
HBIT50 AK	56 ~ 74	62	50	HBIT50	RKCC5674	apr50	1.07
HBIT50 AK	74 ~ 92				RKCC7492		1.09
HBIT63 AK	70 ~ 90	58	63	HBIT63	RKCC7090	apr63	1.74
HBIT63 AK	90 ~ 110				RKCC90110		1.79
HBIT80 AK	90 ~ 130	58	63	HBIT80	RKCC90130	apr80	2.23
HBIT80 AK	130 ~ 170				RKCC130170		2.30



## Adjustable Twin Cutter Roughing and Semi-Finishing Boring System

(AA type)

**STANNY** IMP

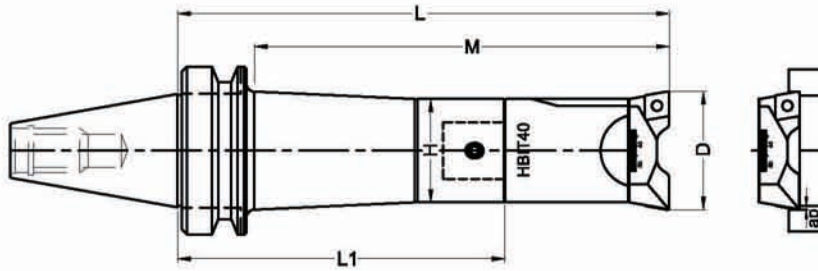

Model	Boring Range Ødmin ~ Ødmax	M	L	Adjustable Twin Cutter Boring System			N.W.	
				Taper Shank	Boring Head	Cutting Insert Holder		
BT30-HBIT25-60	AA 29 ~ 36	60	85	BT30-H25-35	HBIT25	SACC2936	SACC2936	0.57
BT30-HBIT25-75	AA 29 ~ 36	75	105	BT30-H25-55		SACC3542	SACC3542	0.66
BT30-HBIT25-60	AA 35 ~ 42	60	85	BT30-H25-35	HBIT25	SACC3542	SACC3542	0.59
BT30-HBIT25-75	AA 35 ~ 42	75	105	BT30-H25-55		SACC3645	SACC3645	0.68
BT30-HBIT32-75	AA 36 ~ 45	75	98	BT30-H32-35	HBIT32	SACC3645	SACC3645	0.82
BT30-HBIT32-93	AA 36 ~ 45	93	118	BT30-H32-55		SACC4453	SACC4453	0.91
BT30-HBIT32-75	AA 44 ~ 53	75	98	BT30-H32-35		SACC4453	SACC4453	0.82
BT30-HBIT32-93	AA 44 ~ 53	93	118	BT30-H32-55	HBIT32	SACC4453	SACC4453	0.91
BT30-HBIT40-75	AA 45 ~ 56	75	98	BT30-H40-35		SACC4556	SACC4556	1.01
BT30-HBIT40-93	AA 45 ~ 56	93	118	BT30-H40-55		SACC5566	SACC5566	1.19
BT30-HBIT40-75	AA 55 ~ 66	75	98	BT30-H40-35	HBIT40	SACC5566	SACC5566	1.03
BT30-HBIT40-93	AA 55 ~ 66	93	118	BT30-H40-55		SACC5674	SACC5674	1.21
BT30-HBIT50-93	AA 56 ~ 74	93	125	BT30-H50-45	HBIT50	SACC5674	SACC5674	2.25
BT30-HBIT50-93	AA 74 ~ 92			BT30-H50-45		SACC7492	SACC7492	2.29

BT40-HBIT25-60	AA 29 ~ 36	60	90	BT40-H25-40	HBIT25	SACC2936	SACC2936	1.17
BT40-HBIT25-90	AA 29 ~ 36	90	122	BT40-H25-72				1.29
BT40-HBIT25-123	AA 29 ~ 36	123	150	BT40-H25-100		1.64		
BT40-HBIT25-60	AA 35 ~ 42	60	90	BT40-H25-40		SACC3542	SACC3542	1.19
BT40-HBIT25-90	AA 35 ~ 42	90	122	BT40-H25-72	1.31			
BT40-HBIT25-123	AA 35 ~ 42	123	150	BT40-H25-100	HBIT25	SACC3542	SACC3542	1.66
BT40-HBIT32-75	AA 36 ~ 45	75	103	BT40-H32-40				1.37
BT40-HBIT32-102	AA 36 ~ 45	102	135	BT40-H32-72	HBIT32	SACC3645	SACC3645	1.57
BT40-HBIT32-150	AA 36 ~ 45	150	183	BT40-H32-100				1.92
BT40-HBIT32-75	AA 44 ~ 53	75	103	BT40-H32-40		SACC4453	SACC4453	1.37
BT40-HBIT32-102	AA 44 ~ 53	102	135	BT40-H32-72	1.57			
BT40-HBIT32-150	AA 44 ~ 53	150	183	BT40-H32-100	HBIT32	SACC4453	SACC4453	1.92
BT40-HBIT40-73	AA 45 ~ 56	73	103	BT40-H40-40				1.61
BT40-HBIT40-102	AA 45 ~ 56	102	135	BT40-H40-72	HBIT40	SACC4556	SACC4556	1.87
BT40-HBIT40-162	AA 45 ~ 56	162	193	BT40-H40-130				2.51
BT40-HBIT40-73	AA 55 ~ 66	73	103	BT40-H40-40		SACC5566	SACC5566	1.63
BT40-HBIT40-102	AA 55 ~ 66	102	135	BT40-H40-72	1.89			
BT40-HBIT40-162	AA 55 ~ 66	162	193	BT40-H40-130	HBIT40	SACC5566	SACC5566	2.53
BT40-HBIT50-102	AA 56 ~ 74	102	130	BT40-H50-50				SACC5674
BT40-HBIT50-182	AA 56 ~ 74	182	210	BT40-H50-130	HBIT50	SACC5674	SACC5674	3.30
BT40-HBIT50-102	AA 74 ~ 92	102	130	BT40-H50-50				SACC7492
BT40-HBIT50-182	AA 74 ~ 92	182	210	BT40-H50-130	HBIT50	SACC7492	SACC7492	3.34
BT40-HBIT63-102	AA 70 ~ 90	102	135	BT40-H63-55				HBIT63
BT40-HBIT63-102	AA 90 ~ 110				SACC90110	SACC90110	3.14	
BT40-HBIT80-102	AA 90 ~ 130				HBIT80	SACC90130	SACC90130	3.54
BT40-HBIT80-102	AA 130 ~ 170					SACC130170	SACC130170	3.68

## Adjustable Twin Cutter Roughing and Semi-Finishing Boring System

(AA type)

**STANNY** IMP

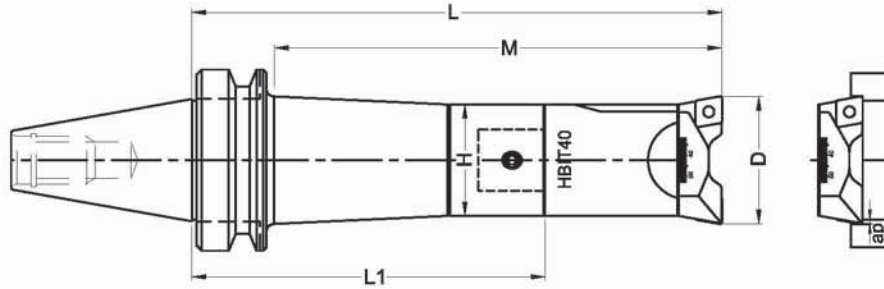

Model	Boring Range ØDmin ~ Ødmax	M	L	Adjustable Twin Cutter Boring System			N.W.
				Taper Shank	Boring Head	Cutting Insert Holder	
BT50-HBIT25-102	AA 29 ~ 36	102	165	BT50-H25-115	HBIT25	SACC2936	4.32
BT50-HBIT25-127	AA 29 ~ 36	127	190	BT50-H25-140			4.47
BT50-HBIT25-152	AA 29 ~ 36	152	215	BT50-H25-165			4.57
BT50-HBIT25-102	AA 35 ~ 42	102	165	BT50-H25-115		SACC3542	4.34
BT50-HBIT25-127	AA 35 ~ 42	127	190	BT50-H25-140			4.49
BT50-HBIT25-152	AA 35 ~ 42	152	215	BT50-H25-165			4.59
BT50-HBIT32-135	AA 36 ~ 45	135	198	BT50-H32-135	HBIT32	SACC3645	4.92
BT50-HBIT32-165	AA 36 ~ 45	165	228	BT50-H32-165			5.17
BT50-HBIT32-200	AA 36 ~ 45	200	263	BT50-H32-200			5.37
BT50-HBIT32-135	AA 44 ~ 53	135	198	BT50-H32-135		SACC4453	4.92
BT50-HBIT32-165	AA 44 ~ 53	165	228	BT50-H32-165			5.17
BT50-HBIT32-200	AA 44 ~ 53	200	263	BT50-H32-200			5.37
BT50-HBIT40-135	AA 45 ~ 56	135	198	BT50-H40-135	HBIT40	SACC4556	5.46
BT50-HBIT40-185	AA 45 ~ 56	185	248	BT50-H40-185			6.01
BT50-HBIT40-225	AA 45 ~ 56	225	288	BT50-H40-225			6.46
BT50-HBIT40-265	AA 45 ~ 56	265	328	BT50-H40-265		SACC5566	6.86
BT50-HBIT40-135	AA 55 ~ 66	135	198	BT50-H40-135			5.48
BT50-HBIT40-185	AA 55 ~ 66	185	248	BT50-H40-185			6.03
BT50-HBIT40-225	AA 55 ~ 66	225	288	BT50-H40-225	HBIT50	SACC5674	6.48
BT50-HBIT40-265	AA 55 ~ 66	265	328	BT50-H40-265			6.88
BT50-HBIT50-102	AA 56 ~ 74	102	145	BT50-H50-65			4.90
BT50-HBIT50-202	AA 56 ~ 74	202	245	BT50-H50-165		SACC7492	6.45
BT50-HBIT50-252	AA 56 ~ 74	252	295	BT50-H50-215			7.40
BT50-HBIT50-302	AA 56 ~ 74	302	345	BT50-H50-265			8.30
BT50-HBIT50-102	AA 74 ~ 92	102	145	BT50-H50-65	HBIT63	SACC7090	4.94
BT50-HBIT50-202	AA 74 ~ 92	202	245	BT50-H50-165			6.49
BT50-HBIT50-252	AA 74 ~ 92	252	295	BT50-H50-215			7.44
BT50-HBIT50-302	AA 74 ~ 92	302	345	BT50-H50-265		SACC90110	8.34
BT50-HBIT63-122	AA 70 ~ 90	122	165	BT50-H63-85			6.08
BT50-HBIT63-202	AA 70 ~ 90	202	245	BT50-H63-165			7.98
BT50-HBIT63-252	AA 70 ~ 90	252	295	BT50-H63-215	HBIT80	SACC90130	9.53
BT50-HBIT63-302	AA 70 ~ 90	302	345	BT50-H63-265			10.48
BT50-HBIT63-352	AA 70 ~ 90	352	395	BT50-H63-315			13.73
BT50-HBIT63-122	AA 90 ~ 110	122	165	BT50-H63-85		SACC130170	6.20
BT50-HBIT63-202	AA 90 ~ 110	202	245	BT50-H63-165			8.10
BT50-HBIT63-252	AA 90 ~ 110	252	295	BT50-H63-215			9.65
BT50-HBIT63-302	AA 90 ~ 110	302	345	BT50-H63-265	HBIT80	SACC130170	10.60
BT50-HBIT63-352	AA 90 ~ 110	352	395	BT50-H63-315			13.85
BT50-HBIT80-122	AA 90 ~ 130	122	165	BT50-H63-85			6.60
BT50-HBIT80-202	AA 90 ~ 130	202	245	BT50-H63-165		SACC90130	8.50
BT50-HBIT80-252	AA 90 ~ 130	252	295	BT50-H63-215			10.05
BT50-HBIT80-302	AA 90 ~ 130	302	345	BT50-H63-265			11.00
BT50-HBIT80-352	AA 90 ~ 130	352	395	BT50-H63-315	HBIT80	SACC130170	14.25
BT50-HBIT80-122	AA 130 ~ 170	122	165	BT50-H63-85			6.74
BT50-HBIT80-202	AA 130 ~ 170	202	245	BT50-H63-165			8.64
BT50-HBIT80-252	AA 130 ~ 170	252	295	BT50-H63-215		SACC130170	10.19
BT50-HBIT80-302	AA 130 ~ 170	302	345	BT50-H63-265			11.14
BT50-HBIT80-352	AA 130 ~ 170	352	395	BT50-H63-315			14.39

## Adjustable Twin Cutter Roughing and Semi-Finishing Boring System (AB type)

**STANNY** IMP

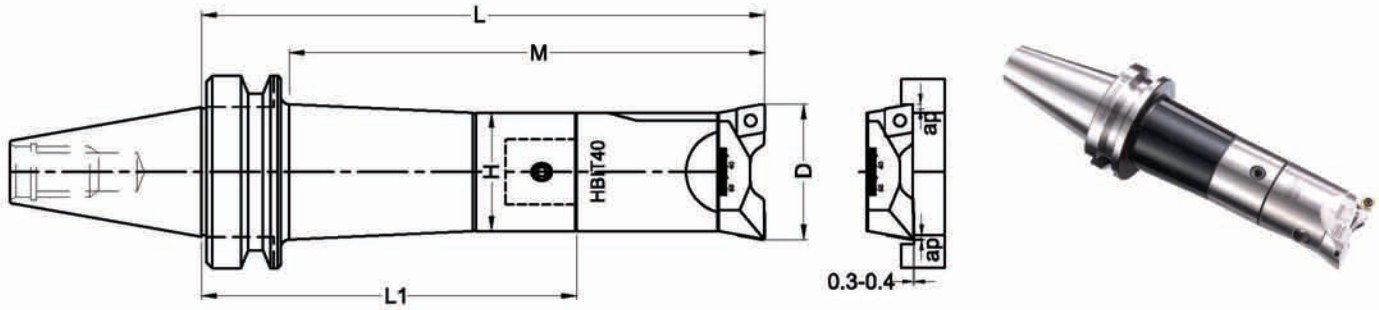

Model	Boring Range ØDmin ~ ØDmax	M	L	Adjustable Twin Cutter Boring System			N.W.	
				Taper Shank	Boring Head	Cutting Insert Holder		
BT30-HBIT25-60	AB 29 ~ 36	60	85	BT30-H25-35	HBIT25	SACC2936	SBCC2936	0.57
BT30-HBIT25-75	AB 29 ~ 36	75	105	BT30-H25-55		SACC3542	SBCC3542	0.66
BT30-HBIT25-60	AB 35 ~ 42	60	85	BT30-H25-35	HBIT25	SACC3542	SBCC3542	0.59
BT30-HBIT25-75	AB 35 ~ 42	75	105	BT30-H25-55		SACC3645	SBCC3645	0.68
BT30-HBIT32-75	AB 36 ~ 45	75	98	BT30-H32-35	HBIT32	SACC3645	SBCC3645	0.82
BT30-HBIT32-93	AB 36 ~ 45	93	118	BT30-H32-55		SACC4453	SBCC4453	0.91
BT30-HBIT32-75	AB 44 ~ 53	75	98	BT30-H32-35	HBIT32	SACC4453	SBCC4453	0.82
BT30-HBIT32-93	AB 44 ~ 53	93	118	BT30-H32-55		SACC4556	SBCC4556	0.91
BT30-HBIT40-75	AB 45 ~ 56	75	98	BT30-H40-35	HBIT40	SACC4556	SBCC4556	1.01
BT30-HBIT40-93	AB 45 ~ 56	93	118	BT30-H40-55		SACC5566	SBCC5566	1.19
BT30-HBIT40-75	AB 55 ~ 66	75	98	BT30-H40-35	HBIT40	SACC5566	SBCC5566	1.03
BT30-HBIT40-93	AB 55 ~ 66	93	118	BT30-H40-55		SACC5674	SBCC5674	1.21
BT30-HBIT50-93	AB 56 ~ 74	93	125	BT30-H50-45	HBIT50	SACC5674	SBCC5674	2.25
BT30-HBIT50-93	AB 74 ~ 92			BT30-H50-45		SACC7492	SBCC7492	2.29

BT40-HBIT25-60	AB 29 ~ 36	60	90	BT40-H25-40	HBIT25	SACC2936	SBCC2936	1.17
BT40-HBIT25-90	AB 29 ~ 36	90	122	BT40-H25-72		SACC2936	SBCC2936	1.29
BT40-HBIT25-123	AB 29 ~ 36	123	150	BT40-H25-100	HBIT25	SACC3542	SBCC3542	1.64
BT40-HBIT25-60	AB 35 ~ 42	60	90	BT40-H25-40		SACC3542	SBCC3542	1.19
BT40-HBIT25-90	AB 35 ~ 42	90	122	BT40-H25-72	HBIT25	SACC3542	SBCC3542	1.31
BT40-HBIT25-123	AB 35 ~ 42	123	150	BT40-H25-100		SACC3645	SBCC3645	1.66
BT40-HBIT32-75	AB 36 ~ 45	75	103	BT40-H32-40	HBIT32	SACC3645	SBCC3645	1.37
BT40-HBIT32-102	AB 36 ~ 45	102	135	BT40-H32-72		SACC3645	SBCC3645	1.57
BT40-HBIT32-150	AB 36 ~ 45	150	183	BT40-H32-100	HBIT32	SACC4453	SBCC4453	1.92
BT40-HBIT32-75	AB 44 ~ 53	75	103	BT40-H32-40		SACC4453	SBCC4453	1.37
BT40-HBIT32-102	AB 44 ~ 53	102	135	BT40-H32-72	HBIT32	SACC4453	SBCC4453	1.57
BT40-HBIT32-150	AB 44 ~ 53	150	183	BT40-H32-100		SACC4556	SBCC4556	1.92
BT40-HBIT40-73	AB 45 ~ 56	73	103	BT40-H40-40	HBIT40	SACC4556	SBCC4556	1.61
BT40-HBIT40-102	AB 45 ~ 56	102	135	BT40-H40-72		SACC4556	SBCC4556	1.87
BT40-HBIT40-162	AB 45 ~ 56	162	193	BT40-H40-130	HBIT40	SACC4556	SBCC4556	2.51
BT40-HBIT40-73	AB 55 ~ 66	73	103	BT40-H40-40		SACC5566	SBCC5566	1.63
BT40-HBIT40-102	AB 55 ~ 66	102	135	BT40-H40-72	HBIT40	SACC5566	SBCC5566	1.89
BT40-HBIT40-162	AB 55 ~ 66	162	193	BT40-H40-130		SACC5674	SBCC5674	2.53
BT40-HBIT50-102	AB 56 ~ 74	102	130	BT40-H50-50	HBIT50	SACC5674	SBCC5674	2.25
BT40-HBIT50-182	AB 56 ~ 74	182	210	BT40-H50-130		SACC5674	SBCC5674	3.30
BT40-HBIT50-102	AB 74 ~ 92	102	130	BT40-H50-50	HBIT50	SACC7492	SBCC7492	2.29
BT40-HBIT50-182	AB 74 ~ 92	182	210	BT40-H50-130		SACC7492	SBCC7492	3.34
BT40-HBIT63-102	AB 70 ~ 90	102	135	BT40-H63-55	HBIT63	SACC7090	SBCC7090	3.02
BT40-HBIT63-102	AB 90 ~ 110					SACC90110	SBCC90110	3.14
BT40-HBIT80-102	AB 90 ~ 130	102	135	BT40-H63-55	HBIT80	SACC90130	SBCC90130	3.54
BT40-HBIT80-102	AB 130 ~ 170					SACC130170	SBCC130170	3.68

## Adjustable Twin Cutter Roughing and Semi-Finishing Boring System (AB type)

**STANNY** IMP

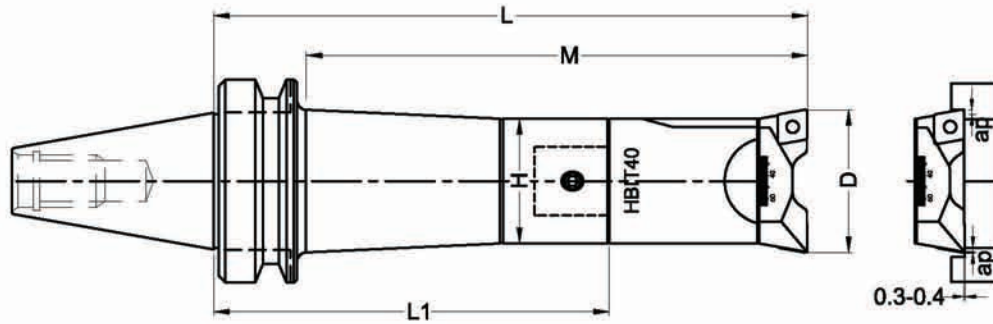

Model	Boring Range ØDmin ~ Ødmax	M	L	Adjustable Twin Cutter Boring System			N.W.	
				Taper Shank	Boring Head	Cutting Insert Holder		
BT50-HBIT25-102	AB 29 ~ 36	102	165	BT50-H25-115	HBIT25	SACC2936	SBCC2936	4.32
BT50-HBIT25-127	AB 29 ~ 36	127	190	BT50-H25-140		SACC3542	SBCC3542	4.47
BT50-HBIT25-152	AB 29 ~ 36	152	215	BT50-H25-165		SACC3542	SBCC3542	4.57
BT50-HBIT25-102	AB 35 ~ 42	102	165	BT50-H25-115		SACC3542	SBCC3542	4.34
BT50-HBIT25-127	AB 35 ~ 42	127	190	BT50-H25-140		SACC3542	SBCC3542	4.49
BT50-HBIT25-152	AB 35 ~ 42	152	215	BT50-H25-165		SACC3542	SBCC3542	4.59
BT50-HBIT32-135	AB 36 ~ 45	135	198	BT50-H32-135	HBIT32	SACC3645	SBCC3645	4.92
BT50-HBIT32-165	AB 36 ~ 45	165	228	BT50-H32-165		SACC3645	SBCC3645	5.17
BT50-HBIT32-200	AB 36 ~ 45	200	263	BT50-H32-200		SACC3645	SBCC3645	5.37
BT50-HBIT32-135	AB 44 ~ 53	135	198	BT50-H32-135		SACC4453	SBCC4453	4.92
BT50-HBIT32-165	AB 44 ~ 53	165	228	BT50-H32-165		SACC4453	SBCC4453	5.17
BT50-HBIT32-200	AB 44 ~ 53	200	263	BT50-H32-200		SACC4453	SBCC4453	5.37
BT50-HBIT40-135	AB 45 ~ 56	135	198	BT50-H40-135	HBIT40	SACC4556	SBCC4556	5.46
BT50-HBIT40-185	AB 45 ~ 56	185	248	BT50-H40-185		SACC4556	SBCC4556	6.01
BT50-HBIT40-225	AB 45 ~ 56	225	288	BT50-H40-225		SACC4556	SBCC4556	6.46
BT50-HBIT40-265	AB 45 ~ 56	265	328	BT50-H40-265		SACC4556	SBCC4556	6.86
BT50-HBIT40-135	AB 55 ~ 66	135	198	BT50-H40-135		SACC5566	SBCC5566	5.48
BT50-HBIT40-185	AB 55 ~ 66	185	248	BT50-H40-185		SACC5566	SBCC5566	6.03
BT50-HBIT40-225	AB 55 ~ 66	225	288	BT50-H40-225	SACC5566	SBCC5566	6.48	
BT50-HBIT40-265	AB 55 ~ 66	265	328	BT50-H40-265	SACC5566	SBCC5566	6.88	
BT50-HBIT50-102	AB 56 ~ 74	102	145	BT50-H50-65	HBIT50	SACC5674	SBCC5674	4.90
BT50-HBIT50-202	AB 56 ~ 74	202	245	BT50-H50-165		SACC5674	SBCC5674	6.45
BT50-HBIT50-252	AB 56 ~ 74	252	295	BT50-H50-215		SACC5674	SBCC5674	7.40
BT50-HBIT50-302	AB 56 ~ 74	302	345	BT50-H50-265		SACC5674	SBCC5674	8.30
BT50-HBIT50-102	AB 74 ~ 92	102	145	BT50-H50-65		SACC7492	SBCC7492	4.94
BT50-HBIT50-202	AB 74 ~ 92	202	245	BT50-H50-165		SACC7492	SBCC7492	6.49
BT50-HBIT50-252	AB 74 ~ 92	252	295	BT50-H50-215	SACC7492	SBCC7492	7.44	
BT50-HBIT50-302	AB 74 ~ 92	302	345	BT50-H50-265	SACC7492	SBCC7492	8.34	
BT50-HBIT63-122	AB 70 ~ 90	122	165	BT50-H63-85	HBIT63	SACC7090	SBCC7090	6.08
BT50-HBIT63-202	AB 70 ~ 90	202	245	BT50-H63-165		SACC7090	SBCC7090	7.98
BT50-HBIT63-252	AB 70 ~ 90	252	295	BT50-H63-215		SACC7090	SBCC7090	9.53
BT50-HBIT63-302	AB 70 ~ 90	302	345	BT50-H63-265		SACC7090	SBCC7090	10.48
BT50-HBIT63-352	AB 70 ~ 90	352	395	BT50-H63-315		SACC7090	SBCC7090	13.73
BT50-HBIT63-122	AB 90 ~ 110	122	165	BT50-H63-85		SACC90110	SBCC90110	6.20
BT50-HBIT63-202	AB 90 ~ 110	202	245	BT50-H63-165	SACC90110	SBCC90110	8.10	
BT50-HBIT63-252	AB 90 ~ 110	252	295	BT50-H63-215	SACC90110	SBCC90110	9.65	
BT50-HBIT63-302	AB 90 ~ 110	302	345	BT50-H63-265	SACC90110	SBCC90110	10.60	
BT50-HBIT63-352	AB 90 ~ 110	352	395	BT50-H63-315	SACC90110	SBCC90110	13.85	
BT50-HBIT80-122	AB 90 ~ 130	122	165	BT50-H63-85	HBIT80	SACC90130	SBCC90130	6.60
BT50-HBIT80-202	AB 90 ~ 130	202	245	BT50-H63-165		SACC90130	SBCC90130	8.50
BT50-HBIT80-252	AB 90 ~ 130	252	295	BT50-H63-215		SACC90130	SBCC90130	10.05
BT50-HBIT80-302	AB 90 ~ 130	302	345	BT50-H63-265		SACC90130	SBCC90130	11.00
BT50-HBIT80-352	AB 90 ~ 130	352	395	BT50-H63-315		SACC90130	SBCC90130	14.25
BT50-HBIT80-122	AB 130 ~ 170	122	165	BT50-H63-85		SACC130170	SBCC130170	6.74
BT50-HBIT80-202	AB 130 ~ 170	202	245	BT50-H63-165	SACC130170	SBCC130170	8.64	
BT50-HBIT80-252	AB 130 ~ 170	252	295	BT50-H63-215	SACC130170	SBCC130170	10.19	
BT50-HBIT80-302	AB 130 ~ 170	302	345	BT50-H63-265	SACC130170	SBCC130170	11.14	
BT50-HBIT80-352	AB 130 ~ 170	352	395	BT50-H63-315	SACC130170	SBCC130170	14.39	

# Adjustable Reverse Roughing and Semi-Finishing Boring System

**STANNY** IMP

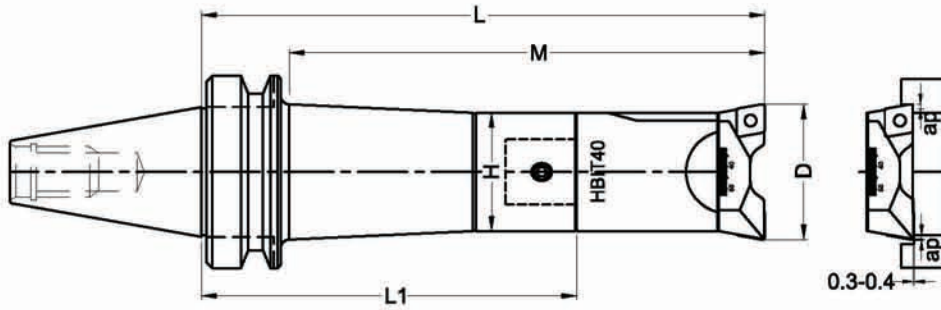

Model	Boring Range ØDmin ~ ØDmax	M	L	Adjustable Twin Cutter Boring System			N.W.	
				Taper Shank	Boring Head	Cutting Insert Holder		
BT30-HBIT25-60	AB 29 ~ 36	60	85	BT30-H25-35	HBIT25	SACC2936	SBCC2936	0.57
BT30-HBIT25-75	AB 29 ~ 36	75	105	BT30-H25-55		SACC3542	SBCC3542	0.66
BT30-HBIT25-60	AB 35 ~ 42	60	85	BT30-H25-35	HBIT25	SACC3542	SBCC3542	0.59
BT30-HBIT25-75	AB 35 ~ 42	75	105	BT30-H25-55		SACC3645	SBCC3645	0.68
BT30-HBIT32-75	AB 36 ~ 45	75	98	BT30-H32-35	HBIT32	SACC3645	SBCC3645	0.82
BT30-HBIT32-93	AB 36 ~ 45	93	118	BT30-H32-55		SACC4453	SBCC4453	0.91
BT30-HBIT32-75	AB 44 ~ 53	75	98	BT30-H32-35	HBIT32	SACC4453	SBCC4453	0.82
BT30-HBIT32-93	AB 44 ~ 53	93	118	BT30-H32-55		SACC4556	SBCC4556	0.91
BT30-HBIT40-75	AB 45 ~ 56	75	98	BT30-H40-35	HBIT40	SACC4556	SBCC4556	1.01
BT30-HBIT40-93	AB 45 ~ 56	93	118	BT30-H40-55		SACC5566	SBCC5566	1.19
BT30-HBIT40-75	AB 55 ~ 66	75	98	BT30-H40-35	HBIT40	SACC5566	SBCC5566	1.03
BT30-HBIT40-93	AB 55 ~ 66	93	118	BT30-H40-55		SACC5674	SBCC5674	1.21
BT30-HBIT50-93	AB 56 ~ 74	93	125	BT30-H50-45	HBIT50	SACC5674	SBCC5674	2.25
BT30-HBIT50-93	AB 74 ~ 92			BT30-H50-45		SACC7492	SBCC7492	2.29

BT40-HBIT25-60	AB 29 ~ 36	60	90	BT40-H25-40	HBIT25	SACC2936	SBCC2936	1.17
BT40-HBIT25-90	AB 29 ~ 36	90	122	BT40-H25-72		SACC2936	SBCC2936	1.29
BT40-HBIT25-123	AB 29 ~ 36	123	150	BT40-H25-100	HBIT25	SACC2936	SBCC2936	1.64
BT40-HBIT25-60	AB 35 ~ 42	60	90	BT40-H25-40		SACC3542	SBCC3542	1.19
BT40-HBIT25-90	AB 35 ~ 42	90	122	BT40-H25-72	HBIT25	SACC3542	SBCC3542	1.31
BT40-HBIT25-123	AB 35 ~ 42	123	150	BT40-H25-100		SACC3542	SBCC3542	1.66
BT40-HBIT32-75	AB 36 ~ 45	75	103	BT40-H32-40	HBIT32	SACC3645	SBCC3645	1.37
BT40-HBIT32-102	AB 36 ~ 45	102	135	BT40-H32-72		SACC3645	SBCC3645	1.57
BT40-HBIT32-150	AB 36 ~ 45	150	183	BT40-H32-100	HBIT32	SACC3645	SBCC3645	1.92
BT40-HBIT32-75	AB 44 ~ 53	75	103	BT40-H32-40		SACC4453	SBCC4453	1.37
BT40-HBIT32-102	AB 44 ~ 53	102	135	BT40-H32-72	HBIT32	SACC4453	SBCC4453	1.57
BT40-HBIT32-150	AB 44 ~ 53	150	183	BT40-H32-100		SACC4453	SBCC4453	1.92
BT40-HBIT40-73	AB 45 ~ 56	73	103	BT40-H40-40	HBIT40	SACC4556	SBCC4556	1.61
BT40-HBIT40-102	AB 45 ~ 56	102	135	BT40-H40-72		SACC4556	SBCC4556	1.87
BT40-HBIT40-162	AB 45 ~ 56	162	193	BT40-H40-130	HBIT40	SACC4556	SBCC4556	2.51
BT40-HBIT40-73	AB 55 ~ 66	73	103	BT40-H40-40		SACC5566	SBCC5566	1.63
BT40-HBIT40-102	AB 55 ~ 66	102	135	BT40-H40-72	HBIT40	SACC5566	SBCC5566	1.89
BT40-HBIT40-162	AB 55 ~ 66	162	193	BT40-H40-130		SACC5566	SBCC5566	2.53
BT40-HBIT50-102	AB 56 ~ 74	102	130	BT40-H50-50	HBIT50	SACC5674	SBCC5674	2.25
BT40-HBIT50-182	AB 56 ~ 74	182	210	BT40-H50-130		SACC5674	SBCC5674	3.30
BT40-HBIT50-102	AB 74 ~ 92	102	130	BT40-H50-50	HBIT50	SACC7492	SBCC7492	2.29
BT40-HBIT50-182	AB 74 ~ 92	182	210	BT40-H50-130		SACC7492	SBCC7492	3.34
BT40-HBIT63-102	AB 70 ~ 90	102	135	BT40-H63-55	HBIT63	SACC7090	SBCC7090	3.02
BT40-HBIT63-102	AB 90 ~ 110					SACC90110	SBCC90110	3.14
BT40-HBIT80-102	AB 90 ~ 130	102	135	BT40-H63-55	HBIT80	SACC90130	SBCC90130	3.54
BT40-HBIT80-102	AB 130 ~ 170					SACC130170	SBCC130170	3.68





Adjustable Reverse Roughing and Semi-Finishing Boring System

**STANNY** IMP

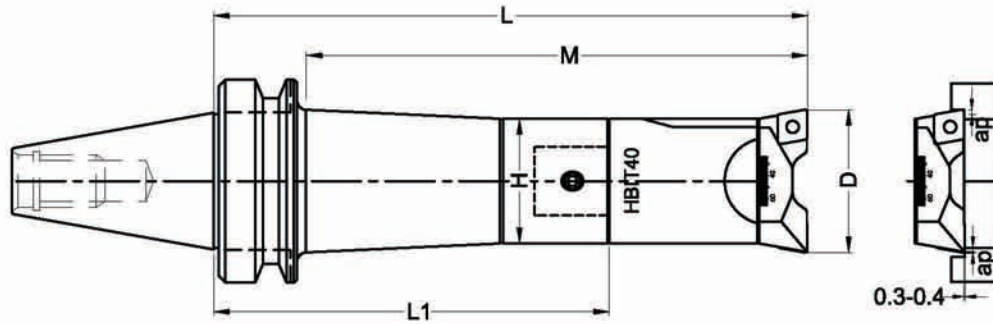

Model	Boring Range ØDmin ~ Ødmax	M	L	Adjustable Twin Cutter Boring System			N.W.	
				Taper Shank	Boring Head	Cutting Insert Holder		
BT50-HBIT25-102	AB 29 ~ 36	102	165	BT50-H25-115	HBIT25	SACC2936	SBCC2936	4.32
BT50-HBIT25-127	AB 29 ~ 36	127	190	BT50-H25-140		SACC3542	SBCC3542	4.47
BT50-HBIT25-152	AB 29 ~ 36	152	215	BT50-H25-165				4.57
BT50-HBIT25-102	AB 35 ~ 42	102	165	BT50-H25-115				4.34
BT50-HBIT25-127	AB 35 ~ 42	127	190	BT50-H25-140				4.49
BT50-HBIT25-152	AB 35 ~ 42	152	215	BT50-H25-165				4.59
BT50-HBIT32-135	AB 36 ~ 45	135	198	BT50-H32-135	HBIT32	SACC3645	SBCC3645	4.92
BT50-HBIT32-165	AB 36 ~ 45	165	228	BT50-H32-165				5.17
BT50-HBIT32-200	AB 36 ~ 45	200	263	BT50-H32-200				5.37
BT50-HBIT32-135	AB 44 ~ 53	135	198	BT50-H32-135				4.92
BT50-HBIT32-165	AB 44 ~ 53	165	228	BT50-H32-165		SACC4453	SBCC4453	5.17
BT50-HBIT32-200	AB 44 ~ 53	200	263	BT50-H32-200				5.37
BT50-HBIT40-135	AB 45 ~ 56	135	198	BT50-H40-135	HBIT40	SACC4556	SBCC4556	5.46
BT50-HBIT40-185	AB 45 ~ 56	185	248	BT50-H40-185				6.01
BT50-HBIT40-225	AB 45 ~ 56	225	288	BT50-H40-225				6.46
BT50-HBIT40-265	AB 45 ~ 56	265	328	BT50-H40-265				6.86
BT50-HBIT40-135	AB 55 ~ 66	135	198	BT50-H40-135				5.48
BT50-HBIT40-185	AB 55 ~ 66	185	248	BT50-H40-185		SACC5566	SBCC5566	6.03
BT50-HBIT40-225	AB 55 ~ 66	225	288	BT50-H40-225			6.48	
BT50-HBIT40-265	AB 55 ~ 66	265	328	BT50-H40-265			6.88	
BT50-HBIT50-102	AB 56 ~ 74	102	145	BT50-H50-65	HBIT50	SACC5674	SBCC5674	4.90
BT50-HBIT50-202	AB 56 ~ 74	202	245	BT50-H50-165				6.45
BT50-HBIT50-252	AB 56 ~ 74	252	295	BT50-H50-215				7.40
BT50-HBIT50-302	AB 56 ~ 74	302	345	BT50-H50-265				8.30
BT50-HBIT50-102	AB 74 ~ 92	102	145	BT50-H50-65				4.94
BT50-HBIT50-202	AB 74 ~ 92	202	245	BT50-H50-165		SACC7492	SBCC7492	6.49
BT50-HBIT50-252	AB 74 ~ 92	252	295	BT50-H50-215			7.44	
BT50-HBIT50-302	AB 74 ~ 92	302	345	BT50-H50-265			8.34	
BT50-HBIT63-122	AB 70 ~ 90	122	165	BT50-H63-85	HBIT63	SACC7090	SBCC7090	6.08
BT50-HBIT63-202	AB 70 ~ 90	202	245	BT50-H63-165				7.98
BT50-HBIT63-252	AB 70 ~ 90	252	295	BT50-H63-215				9.53
BT50-HBIT63-302	AB 70 ~ 90	302	345	BT50-H63-265				10.48
BT50-HBIT63-352	AB 70 ~ 90	352	395	BT50-H63-315				13.73
BT50-HBIT63-122	AB 90 ~ 110	122	165	BT50-H63-85				6.20
BT50-HBIT63-202	AB 90 ~ 110	202	245	BT50-H63-165			8.10	
BT50-HBIT63-252	AB 90 ~ 110	252	295	BT50-H63-215	SACC90110	SBCC90110	9.65	
BT50-HBIT63-302	AB 90 ~ 110	302	345	BT50-H63-265			10.60	
BT50-HBIT63-352	AB 90 ~ 110	352	395	BT50-H63-315			13.85	
BT50-HBIT80-122	AB 90 ~ 130	122	165	BT50-H63-85	HBIT80	SACC90130	SBCC90130	6.60
BT50-HBIT80-202	AB 90 ~ 130	202	245	BT50-H63-165				8.50
BT50-HBIT80-252	AB 90 ~ 130	252	295	BT50-H63-215				10.05
BT50-HBIT80-302	AB 90 ~ 130	302	345	BT50-H63-265				11.00
BT50-HBIT80-352	AB 90 ~ 130	352	395	BT50-H63-315				14.25
BT50-HBIT80-122	AB 130 ~ 170	122	165	BT50-H63-85				6.74
BT50-HBIT80-202	AB 130 ~ 170	202	245	BT50-H63-165			8.64	
BT50-HBIT80-252	AB 130 ~ 170	252	295	BT50-H63-215	SACC130170	SBCC130170	10.19	
BT50-HBIT80-302	AB 130 ~ 170	302	345	BT50-H63-265			11.14	
BT50-HBIT80-352	AB 130 ~ 170	352	395	BT50-H63-315			14.39	