

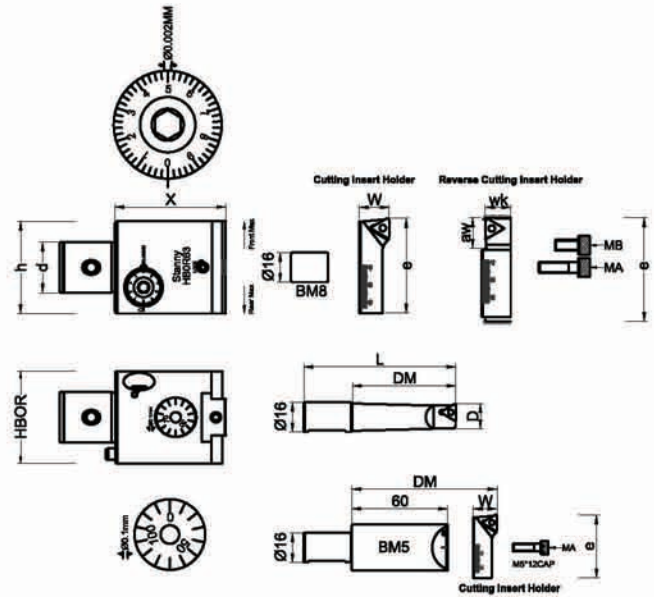

STANNY IMP



Body for H•BOR Micro- Fine Boring

Model	Øh	Ød	Front	Rear	X	MA Bolt	MB Bolt	N.W.
HBOR25	25	14	1	1	42	M5x12	-	0.15
HBOR32	32	18	2	2	52	M6x12	-	0.35
HBOR40	40	22	2	2	53	M6x12	-	0.50
HBOR50	50	28	2	2	63	BM8	-	0.92
HBOR63	63	36	4	4	63	BM8	M8x14	1.52

Cutting Bar for H•BOR50 / H•BOR63 Micro- Fine Boring

Model	Boring Range ØDmin ~ Ødmax	DM	L	System	Insert	Bolt	Wrench	N.W.
BR1606-21	6 ~ 9	21	55	HBOR50 HBOR63	WBG0601..L	SB-1STR-M2	T6	0.04
BR1608-28	8 ~ 11	28	59		TBGT0601..L	SB-1STR-M2	T6	
BR1610-35	10 ~ 13	35	65		TPGH0902..L	SB-2TR-M2.5	T8	0.05
BR1612-42	12 ~ 15	42	70					
BR1614-50	14 ~ 17	50	77					
BR1616-60	16 ~ 20	60	85					
BR1620-65	20 ~ 24	65	88					
BR1624-68	24 ~ 28	68	91					
BM5	-	60 + SRTP2938 or SRTP2652 or SRTP4468			M5x12CAP	Ø4		0.25
BM8	-	+ SRTP5790 or SRTP70110 or SRTP110150			M8x20CAP	Ø6		0.03

Cutting Insert Holder for H•BOR Micro- Fine Boring

Model	Boring Range ØDmin ~ Ødmax	W	e	System	Insert	Bolt	Wrench	N.W.
SRTP2938	29 ~ 36	11	27	HBOR25	TPGH0902..L	SB-2TR-M2.5	T8	0.01
SRTP3652	36 ~ 52	13	35	HBOR32				0.02
SRTP4468	44 ~ 68		43	HBOR40				0.03
SRTP5790	57 ~ 90	20	54	HBOR50	TPGH1103..L	SB-3TR-M3	T8	0.10
SRTP70110	70 ~ 110		66	HBOR63				0.21
SRTP110150	110 ~ 150		106					



Reverse Cutting Insert Holder for H•BOR Micro- Fine Boring

Model	Boring Range ØDmin ~ Ødmax	aw	wk	e	System	Insert	Bolt	Wrench	N.W.
FKTP2938	29 ~ 36	6	11	27	HBOR25	TPGH0902..R	SB-2TR-M2.5	T8	0.01
FKTP3652	36 ~ 52	10		35	HBOR32				0.02
FKTP4468	44 ~ 68	12		43	HBOR40				0.03
FKTP5790	57 ~ 90	14	15	54	HBOR50	TPGH1103..R	SB-3TR-M3	T8	0.10
FKTP70110	70 ~ 110	16		66	HBOR63				0.21
FKTP110150	110 ~ 150	25		106					



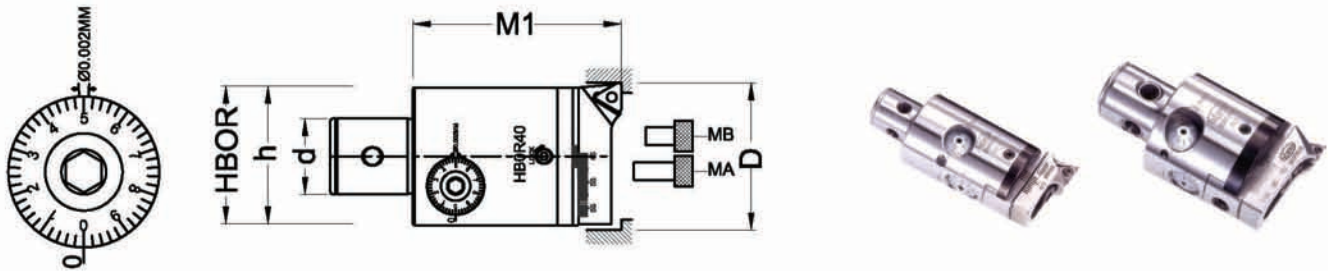

H•BOR Micro- Fine Boring Head

Model	Boring Range ØDmin ~ Ødmax	M1	h	Micro-Finishing Cutter Fine Boring System				N.W.
				Boring Head	MA Bolt	MB Bolt	Cutting Insert Holder	
HBOR25 M	29 ~ 38	50	25	HBOR25	M5x12	-	SRTP2938	0.16
HBOR32 M	36 ~ 52	63	32	HBOR32	M6x12	-	SRTP3652	0.37
HBOR40 M	44 ~ 68		40	HBOR40		-	SRTP4468	0.53
HBOR50 BM	57 ~ 90	80	50	HBOR50	BM8x20	M8x14	SRTP5790	1.05
HBOR63 BM	70 ~ 110		63	HBOR63			SRTP70110	1.65
HBOR63 BM	110 ~ 150		63				SRTP110150	1.76

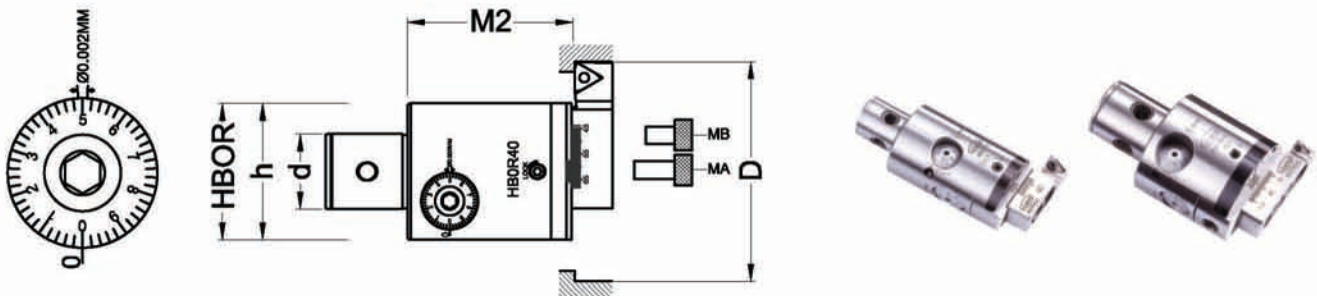

H•BOR for Reverse Fine Boring Head

Model	Boring Range ØDmin ~ Ødmax	M1	h	Micro-Finishing Cutter for Reverse Boring System				N.W.
				Boring Head	MA Bolt	MB Bolt	Reverse Cutting Insert Holder	
HBOR25 MK	29 ~ 38	42	25	HBOR25	M5x12	-	FKTP2938	0.16
HBOR32 MK	36 ~ 52	52	32	HBOR32	M6x12	-	FKTP3652	0.37
HBOR40 MK	44 ~ 68	53	40	HBOR40		-	FKTP4468	0.53
HBOR50 BMK	57 ~ 90	63	50	HBOR50	BM8x20	M8x14	FKTP5790	1.02
HBOR63 BMK	70 ~ 110		63	HBOR63			FKTP70110	1.62
HBOR63 BMK	110 ~ 150		63				FKTP110150	1.73



STANNY IMP

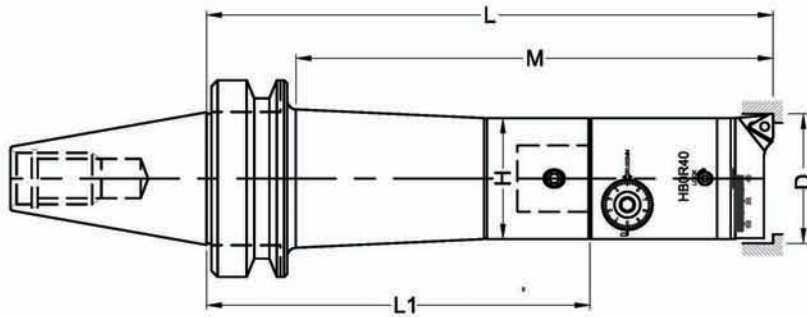

H•BOR Micro- Fine Boring Head

Model	Boring Range ØDmin ~ Ødmax	M	L	Micro-Finishing Cutter Fine Boring System				N.W.
				Taper Shank	Boring Head	Connector	Cutting Insert Holder	
BT30-HBOR25-60	M 29 ~ 38	60	85	BT30-H25-35	HBOR25	M5	SRTP2938	0.56
BT30-HBOR25-75	M 29 ~ 38	75	105	BT30-H25-55				0.62
BT30-HBOR32-75	M 36 ~ 52	98	98	BT30-H32-35	HBOR32	M6	SRTP3652	0.82
BT30-HBOR32-93	M 36 ~ 52	93	118	BT30-H32-55				0.79
BT30-HBOR40-75	M 44 ~ 68	75	98	BT30-H40-35	HBOR40	M6	SRTP4468	0.98
BT30-HBOR40-93	M 44 ~ 68	93	118	BT30-H40-55				0.95
BT30-HBOR50-93	BM 57 ~ 90	93	125	BT30-H50-45	HBOR50	BM8	SRTP5790	1.33

BT40-HBOR25-60	M 29 ~ 38	60	90	BT40-H25-40	HBOR25	M5	SRTP2938	1.16
BT40-HBOR25-90	M 29 ~ 38	90	122	BT40-H25-72				1.28
BT40-HBOR25-123	M 29 ~ 38	123	150	BT40-H25-100				1.63
BT40-HBOR32-75	M 36 ~ 52	75	103	BT40-H32-40	HBOR32	M6	SRTP3652	1.37
BT40-HBOR32-102	M 36 ~ 52	102	135	BT40-H32-72				1.57
BT40-HBOR32-150	M 36 ~ 52	150	183	BT40-H32-120				1.92
BT40-HBOR40-73	M 44 ~ 68	73	103	BT40-H40-40	HBOR40	M6	SRTP4468	1.58
BT40-HBOR40-102	M 44 ~ 68	102	135	BT40-H40-72				1.84
BT40-HBOR40-162	M 44 ~ 68	162	193	BT40-H40-130				2.48
BT40-HBOR50-102	BM 57 ~ 90	102	130	BT40-H50-50	HBOR50	BM8	SRTP5790	1.91
BT40-HBOR50-182	BM 57 ~ 90	182	210	BT40-H50-130				3.25
BT40-HBOR63-102	BM 70 ~ 110	102	135	BT40-H63-55	HBOR63	BM8	SRTP70110	2.51
BT40-HBOR63-102	BM 110 ~ 150							2.6

BT50-HBOR25-102	M 29 ~ 38	102	165	BT50-H25-115	HBOR25	M5	SRTP2938	4.31
BT50-HBOR25-127	M 29 ~ 38	127	190	BT50-H25-140				4.46
BT50-HBOR25-152	M 29 ~ 38	152	215	BT50-H25-165				4.56
BT50-HBOR32-135	M 36 ~ 52	135	198	BT50-H32-135	HBOR32	M6	SRTP3652	4.92
BT50-HBOR32-165	M 36 ~ 52	165	228	BT50-H32-165				5.17
BT50-HBOR32-200	M 36 ~ 52	200	263	BT50-H32-200				5.37
BT50-HBOR40-135	M 44 ~ 68	135	198	BT50-H40-135	HBOR40	M6	SRTP4468	5.43
BT50-HBOR40-185	M 44 ~ 68	185	248	BT50-H40-185				5.98
BT50-HBOR40-225	M 44 ~ 68	225	288	BT50-H40-225				6.43
BT50-HBOR40-265	M 44 ~ 68	265	328	BT50-H40-265	HBOR50	M6	SRTP5790	6.83
BT50-HBOR50-102	BM 57 ~ 90	102	145	BT50-H50-65				4.56
BT50-HBOR50-202	BM 57 ~ 90	202	245	BT50-H50-165				6.11
BT50-HBOR50-252	BM 57 ~ 90	252	295	BT50-H50-215	HBOR50	BM8	SRTP5790	7.06
BT50-HBOR50-302	BM 57 ~ 90	302	345	BT50-H50-265				8.22
BT50-HBOR63-122	BM 70 ~ 110	122	165	BT50-H63-85				5.57
BT50-HBOR63-202	BM 70 ~ 110	202	245	BT50-H63-165	HBOR63	BM8	SRTP70110	7.47
BT50-HBOR63-252	BM 70 ~ 110	252	295	BT50-H63-215				9.02
BT50-HBOR63-302	BM 70 ~ 110	302	345	BT50-H63-265				9.97
BT50-HBOR63-352	BM 70 ~ 110	252	395	BT50-H63-315	HBOR63	BM8	SRTP110150	13.22
BT50-HBOR63-122	BM 110 ~ 150	122	165	BT50-H63-85				5.66
BT50-HBOR63-202	BM 110 ~ 150	202	245	BT50-H63-165				7.56
BT50-HBOR63-252	BM 110 ~ 150	252	295	BT50-H63-215	HBOR63	BM8	SRTP110150	9.11
BT50-HBOR63-302	BM 110 ~ 150	302	345	BT50-H63-265				10.06
BT50-HBOR63-352	BM 110 ~ 150	352	395	BT50-H63-315				13.31



H•BOR MICRO-FINISHING REVERSE FINE BORING HEAD

STANNY IMP

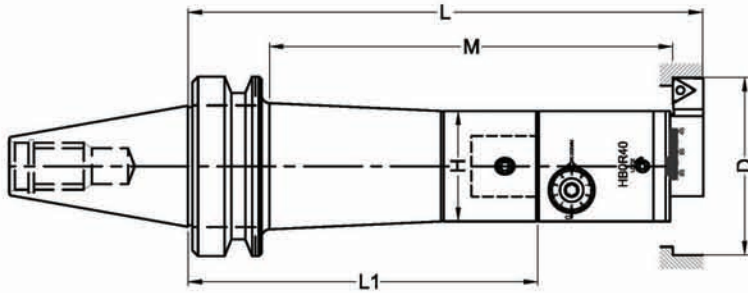

H•BOR Micro-Finishing Reverse Fine Boring Head

Model	Boring Range ØDmin ~ Ødmax	M	L	Micro-Finishing Cutter for Reverse Fine Boring System				N.W.	
				Taper Shank	Boring Head	Connector	Cutting Insert Holder		
BT30-HBOR25-49	MK 29 ~ 38	47	88	BT30-H25-35	HBOR25	M5	FKTP2938	0.56	
BT30-HBOR25-64	MK 29 ~ 38	67	108	BT30-H25-55				0.65	
BT30-HBOR32-62	MK 36 ~ 52	62	98	BT30-H32-35	HBOR32	M6	FKTP3652	0.82	
BT30-HBOR32-80	MK 36 ~ 52	82	118	BT30-H32-55				0.91	
BT30-HBOR40-62	MK 44 ~ 68	63	98	BT30-H40-35	HBOR40			FKTP4468	0.98
BT30-HBOR40-80	MK 44 ~ 68	83	119	BT30-H40-55					1.16
BT30-HBOR50-73	BMK 57 ~ 90	76	123	BT30-H50-45	HBOR50	BM8	FKTP5790	1.59	
BT40-HBOR25-49	MK 29 ~ 38	50	93	BT40-H25-40	HBOR25	M5	FKTP2938	1.16	
BT40-HBOR25-79	MK 29 ~ 38	82	125	BT40-H25-72				1.28	
BT40-HBOR25-112	MK 29 ~ 38	110	153	BT40-H25-100				1.63	
BT40-HBOR32-62	MK 36 ~ 52	59	103	BT40-H32-40	HBOR32	M6	FKTP3652	1.37	
BT40-HBOR32-89	MK 36 ~ 52	91	135	BT40-H32-72				1.57	
BT40-HBOR32-137	MK 36 ~ 52	139	183	BT40-H32-120				1.92	
BT40-HBOR40-60	MK 44 ~ 68	60	104	BT40-H40-40	HBOR40			FKTP4468	1.58
BT40-HBOR40-89	MK 44 ~ 68	92	136	BT40-H40-72					1.84
BT40-HBOR40-149	MK 44 ~ 68	150	194	BT40-H40-130					2.48
BT40-HBOR50-82	BMK 57 ~ 90	85	128	BT40-H50-50	HBOR50	BM8	FKTP5790	2.17	
BT40-HBOR50-162	BMK 57 ~ 90	165	208	BT40-H50-130				3.22	
BT40-HBOR63-82	BMK 70 ~ 110	85	133	BT40-H63-55	HBOR63			FKTP70110	2.86
BT40-HBOR63-82	BMK 110 ~ 150								2.97
BT50-HBOR25-91	MK 29 ~ 38	94	168	BT50-H25-115	HBOR25	M5	FKTP2938		4.31
BT50-HBOR25-116	MK 29 ~ 38	119	193	BT50-H25-140				4.46	
BT50-HBOR25-141	MK 29 ~ 38	144	218	BT50-H25-165	HBOR32	M6	FKTP3652	4.56	
BT50-HBOR32-122	MK 36 ~ 52	124	198	BT50-H32-135				4.92	
BT50-HBOR32-152	MK 36 ~ 52	153	228	BT50-H32-165				5.17	
BT50-HBOR32-187	MK 36 ~ 52	189	263	BT50-H32-200	5.37				
BT50-HBOR40-122	MK 44 ~ 68	125	199	BT50-H40-135	HBOR40			FKTP4468	5.43
BT50-HBOR40-172	MK 44 ~ 68	175	249	BT50-H40-185					5.98
BT50-HBOR40-212	MK 44 ~ 68	215	289	BT50-H40-225		6.43			
BT50-HBOR40-252	MK 44 ~ 68	255	329	BT50-H40-265	HBOR50	FKTP5790	6.83		
BT50-HBOR50-82	BMK 57 ~ 90	85	143	BT50-H50-65			4.82		
BT50-HBOR50-182	BMK 57 ~ 90	185	243	BT50-H50-165			6.37		
BT50-HBOR50-232	BMK 57 ~ 90	235	293	BT50-H50-215			7.32		
BT50-HBOR50-282	BMK 57 ~ 90	285	343	BT50-H50-265	HBOR63	BM8	FKTP5790	8.22	
BT50-HBOR63-102	BMK 70 ~ 110	105	163	BT50-H63-85				5.92	
BT50-HBOR63-182	BMK 70 ~ 110	185	243	BT50-H63-165				7.82	
BT50-HBOR63-232	BMK 70 ~ 110	235	293	BT50-H63-215	9.37				
BT50-HBOR63-282	BMK 70 ~ 110	285	343	BT50-H63-265	10.32				
BT50-HBOR63-332	BMK 70 ~ 110	335	393	BT50-H63-315	13.57				
BT50-HBOR63-102	BMK 110 ~ 150	105	163	BT50-H63-85	FKTP70110	6.03			
BT50-HBOR63-182	BMK 110 ~ 150	185	243	BT50-H63-165		7.93			
BT50-HBOR63-232	BMK 110 ~ 150	235	293	BT50-H63-215		9.48			
BT50-HBOR63-282	BMK 110 ~ 150	285	343	BT50-H63-265		10.43			
BT50-HBOR63-332	BMK 110 ~ 150	335	393	BT50-H63-315		13.68			



STANNY IMP



Model	Boring Range ØDmin ~ Ødmax	Taper Shank		L1	N.W.
BT30-HBOR25P	2 ~ 6	H25	MAS403 BT30-H25-35	35	0.71
BT40-HBOR25P	2 ~ 6	H25	MAS403 BT40-H25-40	40	1.30
SK30-HBOR25P	2 ~ 6	H25	DIN69871A ISO30-H25-30	30	0.66
SK40-HBOR25P	2 ~ 6	H25	DIN69871A ISO40-H25-30	30	0.80
HSK63-HBOR25P	2 ~ 6	H25	DIN69893A HSK63-H25-36	36	1.00

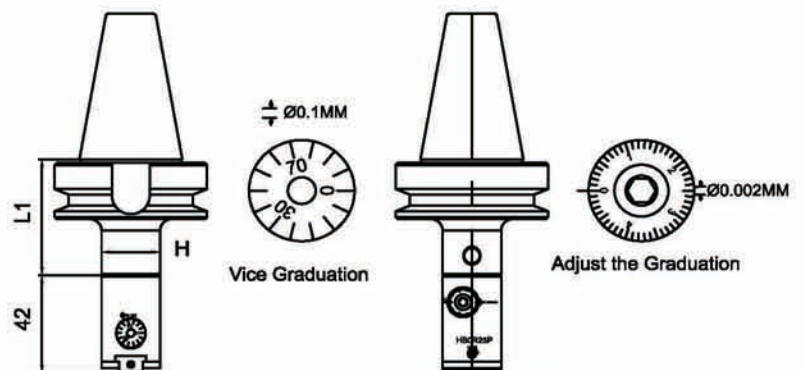

Cutting Bar	Boring Range ØDmin ~ Ødmax	DM	N.W.
CA0602-09	2 ~ 3.2	9	0.01
CA0603-16	3 ~ 4.2	16	
CA0604-22	4 ~ 5.2	22	0.02
CA0605-27	5 ~ 6.2	27	
CA0606-32	6 ~ 7.2	32	

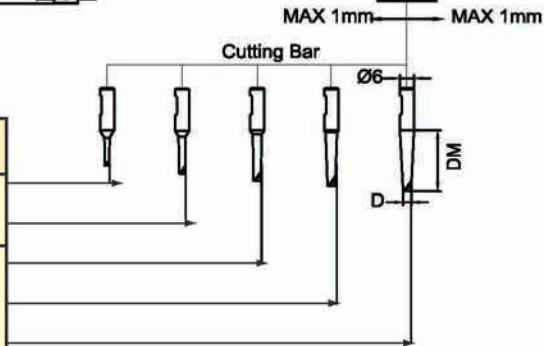



STANNY IMP



Model	Boring Range ØDmin ~ Ødmax	Taper Shank		L1	NW.
BT30-HBOR32P	2 ~ 8	H32	MAS403 BT30-H32-35	35	1.02
BT40-HBOR32P	2 ~ 8	H32	MAS403 BT40-H32-40	40	1.61
SK30-HBOR32P	2 ~ 8	H32	DIN69871A ISO30-H32-35	35	0.97
SK40-HBOR32P	2 ~ 8	H32	DIN69871A ISO40-H32-35	35	1.56
HSK63-HBOR32P	2 ~ 8	H32	DIN69893A HSK63-H32-40	40	1.58

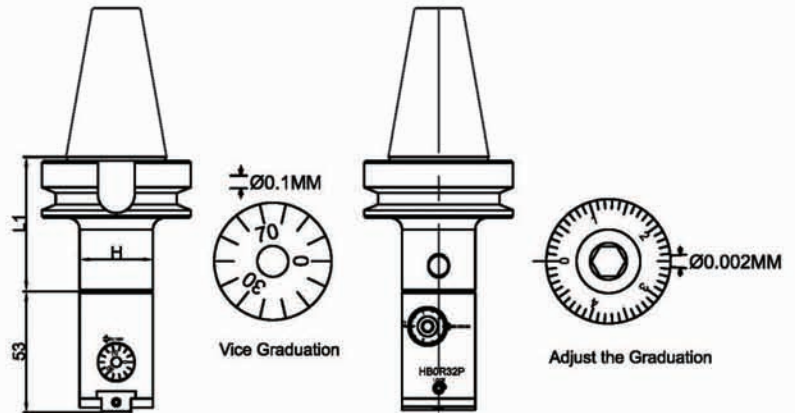

Cutting Bar	Boring Range ØDmin ~ Ødmax	DM	NW.
CA0802-09	2 ~ 3.2	9	
CA0803-16	3 ~ 4.2	16	0.03
CA0804-22	4 ~ 5.2	22	
CA0805-27	5 ~ 6.2	27	
CA0806-32	6 ~ 7.2	32	0.04
CA0807-37	7 ~ 8.2	37	
CA0808-42	8 ~ 9.2	42	0.05

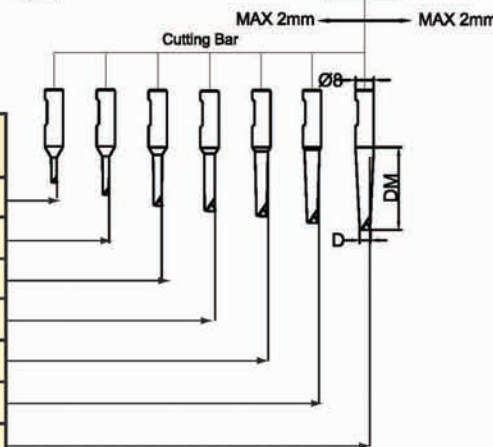



STANNY IMP



Model	Boring Range ØDmin ~ Ødmax	Taper Shank		L1	NW.
BT30-HBOR40P	2 ~ 8	H40	MAS403 BT30-H40-35	35	1.21
BT40-HBOR40P	2 ~ 8	H40	MAS403 BT40-H40-40	40	1.60
SK30-HBOR40P	2 ~ 8	H40	DIN69871A ISO30-H40-35	35	1.16
SK40-HBOR40P	2 ~ 8	H40	DIN69871A ISO40-H40-35	35	1.55
HSK63-HBOR40P	2 ~ 8	H40	DIN69893A HSK63-H40-42	42	1.58

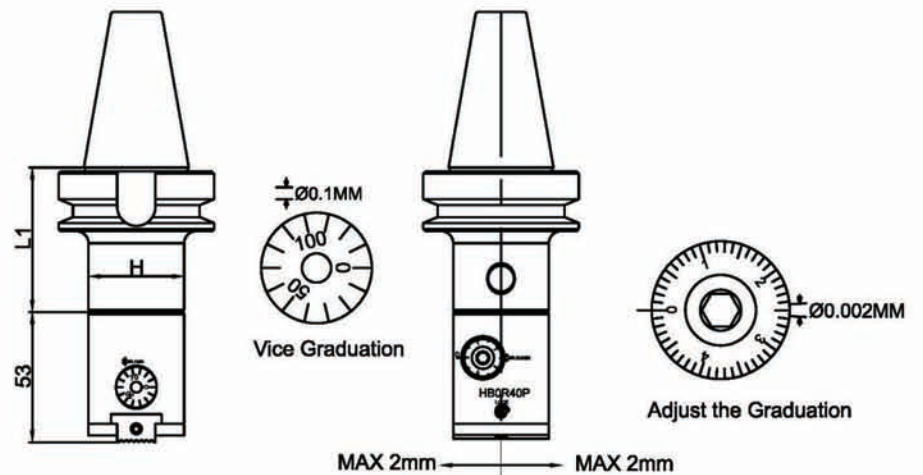

Cutting Bar	Boring Range ØDmin ~ Ødmax	DM	NW.
CA0802-09	2 ~ 3.2	9	0.03
CA0803-16	3 ~ 4.2	16	
CA0804-22	4 ~ 5.2	22	
CA0805-27	5 ~ 6.2	27	0.04
CA0806-32	6 ~ 7.2	32	
CA0807-37	7 ~ 8.2	37	
CA0808-42	8 ~ 9.2	42	

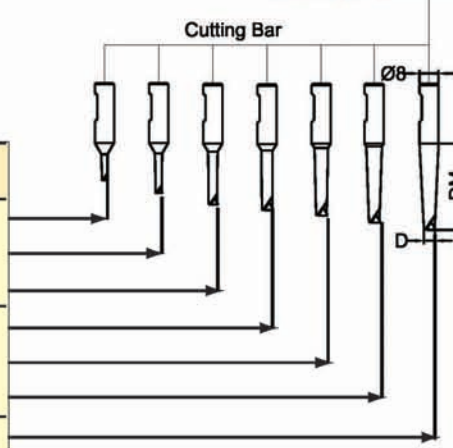

STANNY IMP

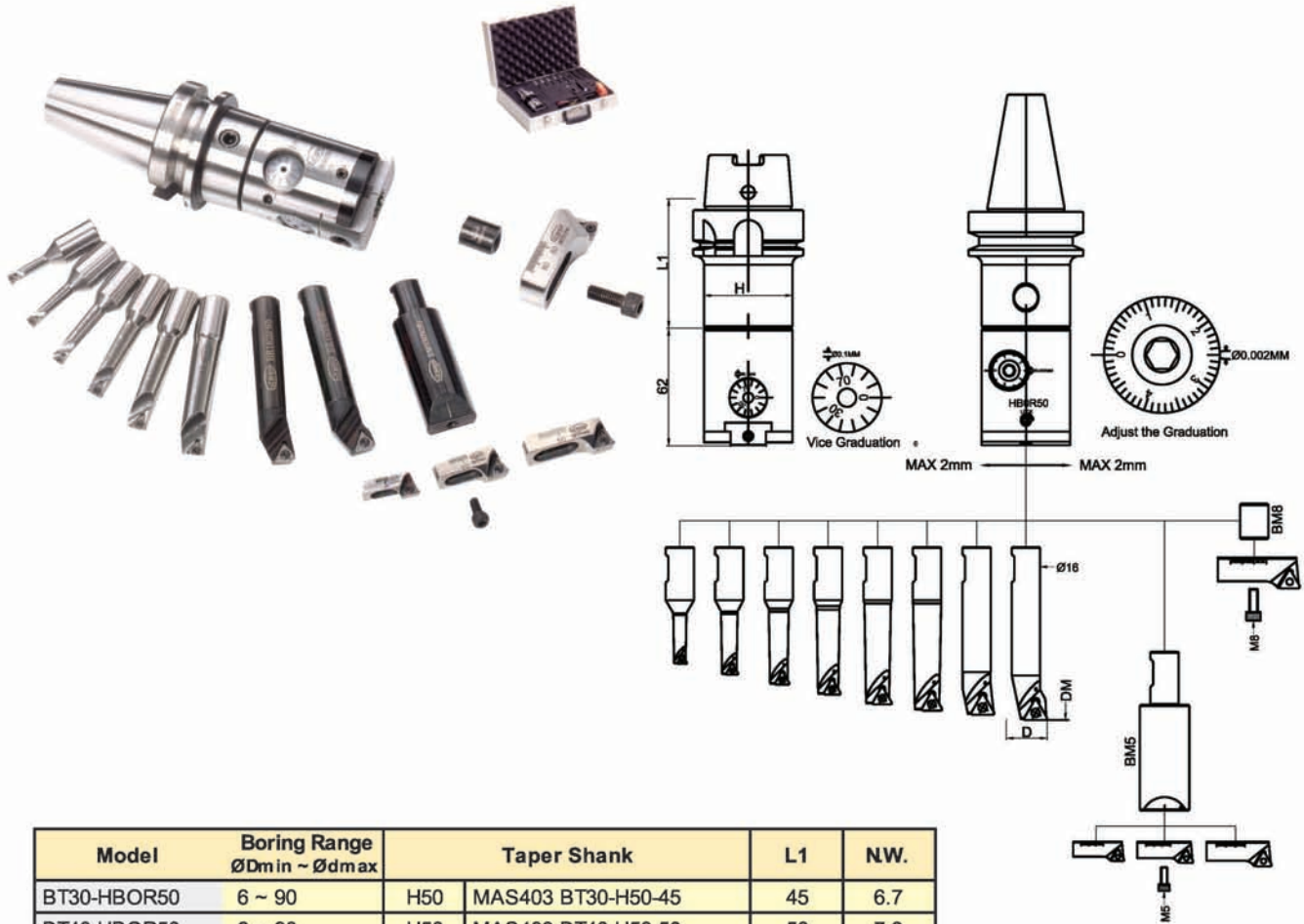

Model	Boring Range ØDmin ~ Ødmax	Taper Shank		L1	NW.
BT30-HBOR50	6 ~ 90	H50	MAS403 BT30-H50-45	45	6.7
BT40-HBOR50	6 ~ 90	H50	MAS403 BT40-H50-50	50	7.3
BT50-HBOR50	6 ~ 90	H50	MAS403 BT50-H50-65	65	9.9
SK30-HBOR50	6 ~ 90	H50	DIN69871A ISO30-H50-55	55	6.8
SK40-HBOR50	6 ~ 90	H50	DIN69871A ISO40-H50-50	50	7.3
SK50-HBOR50	6 ~ 90	H50	DIN69871A ISO50-H50-50	50	9.5
HSK63-HBOR50	6 ~ 90	H50	DIN69893A HSK63-H50-50	50	7.0

Cutting Bar	Boring Range ØDmin ~ Ødmax	DM	Insert	Bolt	Wrench	NW.
BR1606-21	6 ~ 9	21	WBGT0601..L	SB-1STR-M2	T6	0.04
BR1608-28	8 ~ 11	28	TBGT0601..L	SB-1STR-M2	T6	
BR1610-35	10 ~ 13	35	TPGH0902..L	SB-2TR-M2.5	T8	0.05
BR1612-42	12 ~ 15	42				0.06
BR1614-50	14 ~ 17	50				0.07
BR1616-60	16 ~ 20	60	TPGH1103..L	SB-3TR-M3	T8	0.09
BR1620-65	20 ~ 24	65				0.1
BR1624-68	24 ~ 28	68				0.12
BM5		60 + SRTP2938 or SRTP3652 or SRTP4468		M5x12CAP	○4	0.25
SRTP2938	29 ~ 38	+10	TPGH0902..L	SB-2TR-M2.5	T8	0.01
SRTP3652	36 ~ 52	+12				0.02
SRTP4468	44 ~ 68	+12				0.03
BM8		+ SRTP5790		M8x20CAP	○6	0.10
SRTP5790	57 ~ 90	+20	TPGH1103..L	SB-3TR-M3	T8	

STANNY IMP

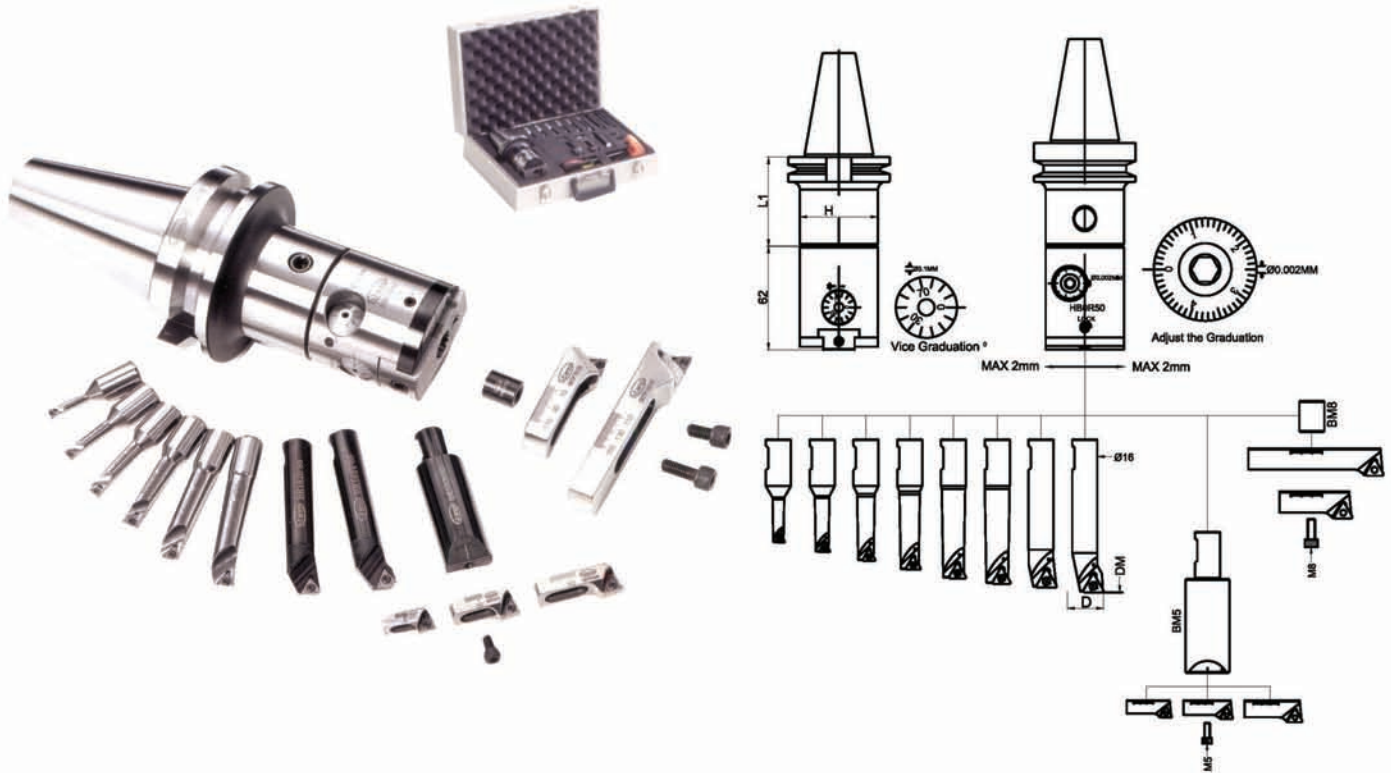

Model	Boring Range ØDmin ~ Ødmax	Taper Shank		L1	NW.
NT40-HBOR63	6 ~ 150	H63	DIN2080 ISO40-H63-55	55	8.4
NT50-HBOR63	6 ~ 150	H63	DIN2080 ISO50-H63-65	65	10.4
BT40-HBOR63	6 ~ 150	H63	MAS403 BT40-H63-55	55	8.2
BT50-HBOR63	6 ~ 150	H63	MAS403 BT50-H63-65	65	10.8
BT50-HBOR63	6 ~ 150	H63	MAS403 BT50-H63-85	85	11.3
SK40-HBOR63	6 ~ 150	H63	DIN69871A ISO40-H63-60	60	8.3
SK50-HBOR63	6 ~ 150	H63	DIN69871A ISO50-H63-65	65	10.0
HSK63-HBOR63	6 ~ 150	H63	DIN69893A HSK63-H63-67	67	8.2

Cutting Bar	Boring Range ØDmin ~ Ødmax	DM	Insert	Bolt	Wrench	NW.
BR1606-21	6 ~ 9	21	WBG0601..L	SB-1STR-M2	T6	0.04
BR1608-28	8 ~ 11	28	TBGT0601..L	SB-1STR-M2	T6	
BR1610-35	10 ~ 13	35	TPGH0902..L	SB-2TR-M2.5	T8	0.05
BR1612-42	12 ~ 15	42				0.06
BR1614-50	14 ~ 17	50				0.07
BR1616-60	16 ~ 20	60	TPGH1103..L	SB-3TR-M3	T8	0.09
BR1620-65	20 ~ 24	65				0.1
BR1624-68	24 ~ 28	68				0.12
BM5		60 + SRTP2938 or SRTP3652 or SRTP4468		M5x12CAP	○4	0.25
SRTP2938	29 ~ 38	+10	TPGH0902..L	SB-2TR-M2.5	T8	0.01
SRTP3652	36 ~ 52	+12				0.02
SRTP4468	44 ~ 68	+12				0.03
BM8		+ SRTP709110 or SRTP110150		M8x20CAP	○6	0.10
SRTP70110	70 ~ 110	+20	TPGH1103..L	SB-3TR-M3	T8	
SRTP110150	110 ~ 150	+20				0.21