

ACROW IMP

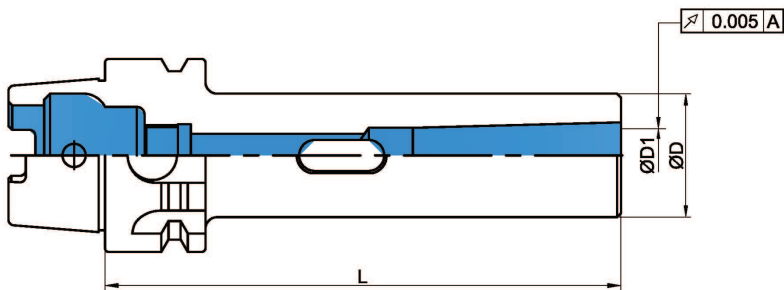

Part No.	M.T.No	ØD	ØD1	L
HSK50A-MT1-100	MT 1	25	12.065	100
-MT2-120	MT 2	32	17.780	120
-MT3-140	MT 3	40	23.825	140

HSK63A-MT1-100	MT 1	25	12.065	100
-MT2-120	MT 2	32	17.780	120
-MT3-140	MT 3	40	23.825	140
-MT4-160	MT 4	48	31.267	160

SM Shell Mill Holders, HSK

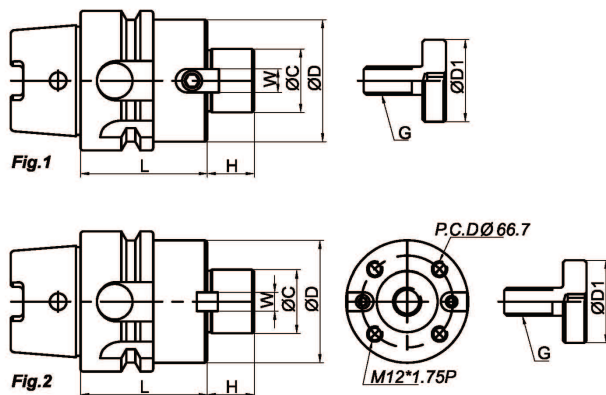

Part No.	Fig.	ØC H5	L	H	W	ØD	ØD1	G
HSK40A-SM16-050	1	16	50	17	8	38	20	M 8 * 1.25P
-SM22-050		22		18	10	48	28	M10 * 1.50P
HSK50A-SM16-050	1	16	60	17	8	38	20	M 8 * 1.25P
-SM22-060		22		18	10	48	28	M10 * 1.50P
-SM27-060		27		20	12	52	35	M12 * 1.75P
HSK63A-SM16-050	1	16	50	17	8	38	20	M 8 * 1.25P
-SM22-050		22		18	10	48	28	M10 * 1.50P
-100		60	27	20	12	58	35	M12 * 1.75P
-SM27-060			32	23	14	78	41	M16 * 2.00P
-100				27	15.9	89	49	M20 * 2.50P
-SM32-060	2	40	60	27	15.9	89	49	M20 * 2.50P
-SM40-060		40		27	15.9	89	49	M20 * 2.50P