

Contacting Chuck



	Range	ØD1	ØD2	ØD3	L1	L2	L3
TC312L	M3	19.0	32.0	15	21.5	25.0	20.0
	M4 ~ M14			18			
TC820L	M8 ~ M12	31.0	50.0	29	35.0	34.0	
	M14 ~ M24						

TAP Collets, Type JIS

JIS TAP			Tap Shank		Order No.	
			ØD	□	TC312 [#1]	TC820 [#2]
M 3		#5, #6	4.0	3.2	010L - 01	
M 4	M4.5	#8	5.0	4.0	010L - 02	
M 5	M5.5	#10	5.5	4.5	010L - 03	
M 6		UNC1/4	6.0		010L - 04	
		UNC5/16	6.1	5.0	010L - 05	
M 8	M 7		6.2		010L - 06	020L - 01
M10	M 9	UNC3/8	7.0	5.5	010L - 07	020L - 02
	M11	UNC7/16	8.0	6.0	010L - 08	020L - 03
M12			8.5	6.5	010L - 09	020L - 04
		UNC1/2	9.0	7.0	010L - 10	020L - 05
M14	M15	UNC9/16	10.5	8.0	010L - 11	020L - 06
		UNC5/8	12.0	9.0		020L - 07
M16			12.5	10.0		020L - 08
M18		UNC3/4	14.0	11.0		020L - 10
M20			15.0	12.0		020L - 11
M22		UNC7/8	17.0	13.0		020L - 12
M24	M25		19.0	15.0		020L - 13
		PT1/8	8.0	6.0	010L - 12	020L - 14
		PT1/4	11.0	9.0	010L - 13	020L - 15
		PT3/8	14.0	11.0		020L - 16
		PT1/2	18.0	14.0		020L - 17

* Only suitable for light / aluminum tapping

TC QUICK CHANGE TAP COLLETS (with overload clutch)

ACROW IMP

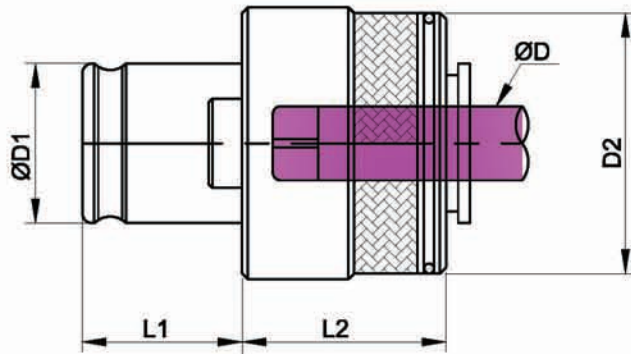

Contacting Chuck



	Range	ØD1	ØD2	L1	L2
TC312	M 3~M12	19.0	32.0	21.5	25.0
TC820	M 8~M20	31.0	50.0	35.0	34.0
TC1433	M14~M33	48.0	72.0	55.0	45.0

TAP	Standard	Tap Shank		Order No.		
		ØD	□	TC312 [#1]	TC820 [#2]	TC1433 [#3]
M 1~ M1.8	DIN371	2.5	2.1	011 - 01		
M 1~ M2	ISO529		2.0	013 - 01		
M 2~ M2.5	DIN371	2.8	2.1	011 - 02		
M2.2~ M2.5	ISO529		2.24	013 - 02		
M 3	ISO529/2283	2.24	1.8	014 - 01		
	ISO529	3.15	2.5	013 - 03		
	DIN371	3.5	2.7	011 - 03		
	#5, #6 JIS	4.0	3.2	010 - 01		
M3.5	ISO529/2283	2.5	2.0	014 - 02		
	DIN376		2.1	012 - 01		
	ISO529	3.55	2.8	013 - 04		
	DIN371	4.0	3.0	011 - 04		
M 4	DIN376	2.8	2.1	012 - 02		
	ISO529/2283	3.15	2.5	014 - 03		
	ISO529	4.0	3.15	013 - 05		
	DIN371	4.5	3.4	011 - 05		
M4.5	#8 JIS	5.0	4.0	010 - 02		
M4.5	DIN376	3.5	2.7	012 - 03		
	ISO529/2283	3.55	2.8	014 - 04		
	ISO529	4.5	3.55	013 - 06		
	DIN371	6.0	4.9	011 - 06		
M 5	DIN376	3.5	2.7	012 - 04		
	ISO529/2283	4.0	3.15	014 - 05		
	ISO529	5.0	4.0	013 - 07		
	M5.5 #10 JIS	5.5	4.5	010 - 03		
	DIN371	6.0	4.9	011 - 07	021 - 01	
M 6	DIN376	4.5	3.4	012 - 05		
	ISO529/2283		3.55	014 - 06		
	DIN371	6.0	4.9	011 - 08	021 - 02	
	UNC1/4 JIS	6.0	4.5	010 - 04		
	ISO529	6.3	5.0	013 - 08	023 - 01	

* Only suitable for light / aluminum tapping



TC QUICK CHANGE TAP COLLETS (with overload clutch)

ACROW IMP

TAP			Standard	Tap Shank		Order No.		
				ØD	□	TC312 [#1]	TC820 [#2]	TC1433 [#3]
M7			DIN376	5.5	4.3	012 - 06		
			ISO529/2283	5.6	4.5	014 - 07		
			ISO529	7.1	5.6	013 - 09	023 - 02	
		UNC5/16	JIS	6.1	5.0	010 - 05		
M8			DIN376	6.0	4.9	012 - 07	022 - 01	
	M7		JIS	6.2	5.0	010 - 06	020 - 01	
			ISO529/2283	6.3		014 - 08	024 - 01	
			DIN371	8.0	6.2	011 - 09	021 - 03	
			ISO529		6.3	013 - 10	023 - 03	
			ISO529/2283	7.1	5.6	014 - 09	024 - 02	
M9			ISO529	9.0	7.1	013 - 11	023 - 04	
M10	M9	UNC3/8	JIS, DIN376	7.0	5.5	010 - 07	020 - 02	
			ISO529/2283	8.0	6.3	014 - 10	024 - 03	
			DIN371, ISO529	10.0	8.0	011 - 10	021 - 04	
	M11	UNC7/16	JIS	8.0	6.0	010 - 08	020 - 03	
		UNC1/2		9.0	7.0	010 - 10	020 - 05	
				8.5	6.5	010 - 09	020 - 04	
M12			DIN376	9.0	7.0	012 - 09	022 - 03	
			ISO529/2283		7.1	014 - 11	024 - 04	
M14	M15	UNC9/16	JIS	10.5	8.0	010 - 11	020 - 06	030 - 01
			DIN376	11.0	9.0	012 - 10	022 - 04	032 - 01
			ISO529/2283	11.2		014 - 12	024 - 05	034 - 01
		UNC5/8	JIS	12.0			020 - 07	030 - 02
M16			DIN376	12.5	10.0		022 - 05	032 - 02
			JIS, ISO529/2283				020 - 08	030 - 03
M18		UNC3/4	JIS, DIN376	14.0	11.0		020 - 10	030 - 05
			ISO529/2283		11.2		024 - 07	034 - 03
							024 - 08	034 - 04
M20			JIS	15.0	12.0		020 - 11	030 - 06
			DIN376				022 - 07	032 - 04
			ISO529/2283			16.0	12.5	024 - 09
M22		UNC7/8	JIS	17.0	13.0		020 - 12	030 - 07
			DIN376	18.0	14.5		022 - 08	032 - 05
			ISO529/2283		14.0	024 - 10	034 - 06	
M24			DIN376		14.5		022 - 09	032 - 06
	M25		JIS	19.0	15.0		020 - 13	030 - 08
M27	M26	UNC1"	20.0					030 - 09
			DIN376, ISO529/2283		16.0			032 - 07
M28			JIS	21.0	17.0			030 - 10
		UNC1-1/8		22.0				030 - 11
M30			ISO529/2283	20.0	16.0			034 - 08
			DIN376	22.0	18.0			032 - 08
			JIS	23.0	17.0			030 - 12
M32		UNC1-1/4	JIS	24.0	19.0			030 - 13
			ISO529/2283	22.4	18.0			034 - 09
M33			DIN376	25.0	20.0			032 - 09
			JIS		19.0			030 - 14
M35	M34	UNC1-3/8	JIS	26.0	21.0			030 - 15
			ISO529/2283	25.0	20.0			034 - 10
M36			JIS	28.0	21.0			030 - 16
			DIN376		22.0			032 - 10
PT1/8			JIS	8.0	6.0	010 - 12	020 - 14	
PT1/4				11.0	9.0	010 - 13	020 - 15	030 - 17
PT3/8				14.0	11.0		020 - 16	030 - 18
PT1/2				18.0	14.0		020 - 17	030 - 19
PT3/4				23.0	17.0			030 - 20
PT1				26	21.0			030 - 21



TC QUICK CHANGE TAP COLLETS (with overload clutch)-(inch size)

ACROW IMP

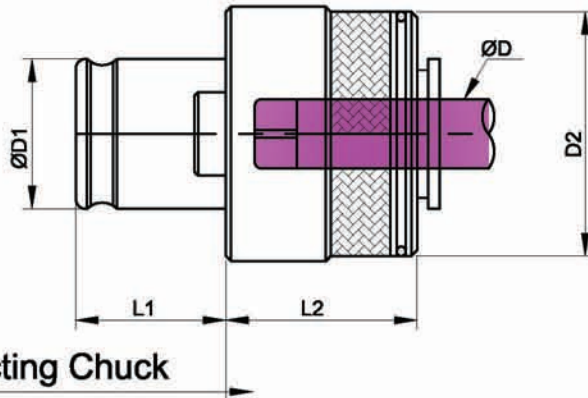

	Range	ØD1	ØD2	L1	L2
TC312	#06 ~ 9/16"	0.75	1.28	0.87	0.98
TC820	5/16" ~ 7/8"	1.22	1.99	1.39	1.34
TC1433	13/16" ~ 1-3/8"	1.89	2.83	2.22	1.77

TAP Collets, Inch size

Tap Size	Tap Shank				Order No.		
	Shank ØD		Square □		TC312 [#1]	TC820 [#2]	TC1433 [#3]
	Inch	mm	Inch	mm			
#06	0.141	3.581	0.110	2.794	E - 010 - 01		
#08	0.168	4.267	0.131	3.327	E - 010 - 02		
#10	0.194	4.928	0.152	3.861	E - 010 - 03		
#12	0.220	5.588	0.165	4.191	E - 010 - 04		
1/4"	0.255	6.477	0.191	4.851	E - 010 - 05		
5/16"	0.318	8.077	0.238	6.045	E - 010 - 06	E - 020 - 01	
3/8"	0.381	9.677	0.286	7.264	E - 010 - 07	E - 020 - 02	
7/16"	0.323	8.204	0.242	6.147	E - 010 - 08	E - 020 - 03	
1/2"	0.367	9.322	0.275	6.985	E - 010 - 09	E - 020 - 04	
9/16"	0.429	10.897	0.322	8.179	E - 010 - 10	E - 020 - 05	
5/8"	0.480	12.192	0.360	9.144		E - 020 - 06	
11/16"	0.542	13.767	0.406	10.312		E - 020 - 07	
3/4"	0.590	14.986	0.442	11.227		E - 020 - 08	
13/16"	0.652	16.561	0.489	12.421		E - 020 - 09	E - 030 - 01
7/8"	0.697	17.704	0.523	13.284		E - 020 - 10	E - 030 - 02
15/16"	0.760	19.304	0.570	14.478			E - 030 - 03
1"	0.800	20.320	0.600	15.240			E - 030 - 04
1-1/8"	0.896	22.758	0.672	17.069			E - 030 - 05
1-1/4"	1.021	25.933	0.766	19.456			E - 030 - 06
1-3/8"	1.108	28.143	0.831	21.107			E - 030 - 07
PT 1/8"S	0.313	7.938	0.234	5.944	E - 010 - 11		
PT 1/8"L	0.437	11.112	0.328	8.331	E - 010 - 12		
PT 1/4"	0.562	14.287	0.421	10.693		E - 020 - 11	
PT 3/8"	0.700	17.780	0.531	13.487		E - 020 - 12	
PT 1/2"	0.687	17.462	0.515	13.081		E - 020 - 13	E - 030 - 08
PT 3/4"	0.906	23.012	0.679	17.247			E - 030 - 09
PT 1"	1.125	28.575	0.843	21.412			E - 030 - 10

Standard setting. Special torque upon request.
 *Only suitable for light / aluminum tapping

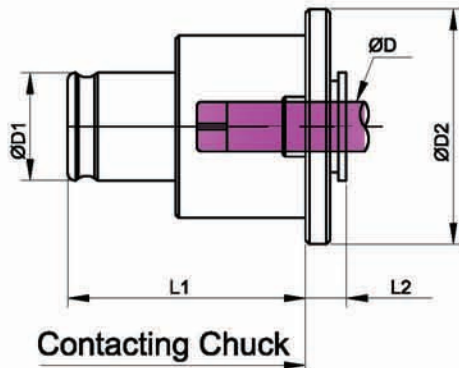

	Capacity	ØD1	ØD2	L1	L2
TC312B	M 3~M12	19.0	30.0	21.5	7.0
TC820B	M 8~M20	31.0	48.0	35	11.0
TC1433B	M14~M33	48.0	70.0	55.0	14.0

TAP Collets, Type JIS

Standard	Tap Shank		Order No.	
	ØD	□	TC312B [#1]	TC820B [#2]
ISO529/2283	2.24	1.8	014B-01	
ISO529,ISO529/2283	2.5	2.0	013B-01	
DIN371,DIN376		2.1	011B-01	
	2.8		011B-02	
ISO529		2.24	013B-02	
ISO529,ISO529/2283	3.15	2.5	013B-03	
DIN371	3.5	2.7	011B-03	
ISO529,ISO529/2283	3.55	2.8	013B-04	
DIN371	4.0	3.0	011B-04	
ISO529,ISO529/2283		3.15	013B-05	
JIS		3.2	010B-01	
DIN371	4.5	3.4	011B-05	
ISO529,ISO529/2283		3.55	013B-06	
JIS	5.0	4.0	010B-02	
DIN376	5.5	4.3	012B-05	
JIS		4.5	010B-03	
ISO529/2283	5.6		014B-07	
JIS	6.0		010B-04	
DIN371,DIN376		4.9	011B-06	021B-01
JIS	6.1	5.0	010B-05	
	6.2		010B-06	020B-01
ISO529,ISO529/2283	6.3		013B-08	023B-01
JIS,DIN376	7.0	5.5	010B-07	020B-02
ISO529,ISO529/2283	7.1	5.6	013B-09	023B-02
JIS		6.0	010B-08	020B-03
DIN371	8.0	6.2	011B-07	021B-02
ISO529,ISO529/2283		6.3	013B-10	023B-03
JIS	8.5	6.5	010B-09	020B-04
	9.0	7.0	010B-10	020B-05

Standard	Tap Shank		Order No.		
	ØD	□	TC312B [#1]	TC820B [#2]	TC1433B [#3]
ISO529,ISO529/2283	9.0	7.1	013B-11	023B-04	
DIN371,ISO529	10.0	8.0	010B-11	021B-03	
JIS			010B-12	020B-06	030B-01
	11.0		014B-12	020B-07	030B-02
ISO529/2283		9.0		024B-05	034B-01
JIS	12.0			020B-08	030B-03
JIS,ISO529/2283	12.5	10.0		020B-09	030B-04
JIS,DIN376	14.0	11.0		020B-11	030B-06
ISO529/2283		11.2		024B-07	034B-03
JIS	15.0	12.0		020B-12	030B-07
DIN376				022B-07	032B-04
ISO529/2283	16.0	12.5		024B-08	034B-04
JIS		13.0		020B-13	030B-08
JIS,ISO529/2283	18.0	14.0		020B-14	030B-09
DIN376		14.5		022B-08	032B-05
JIS	19.0	15.0		020B-15	030B-10
DIN376,ISO529/2283	20.0	16.0			032B-06
JIS	21.0	17.0			030B-12
DIN376	22.0	18.0			032B-07
ISO529/2283					
JIS	23.0	17.0			030B-14
			24.0	19.0	
	25.0	20.0			030B-16
DIN376,ISO529/2283					
JIS	26.0	21.0			030B-17
			28.0		
DIN376	22.0				032B-09



ACROW IMP

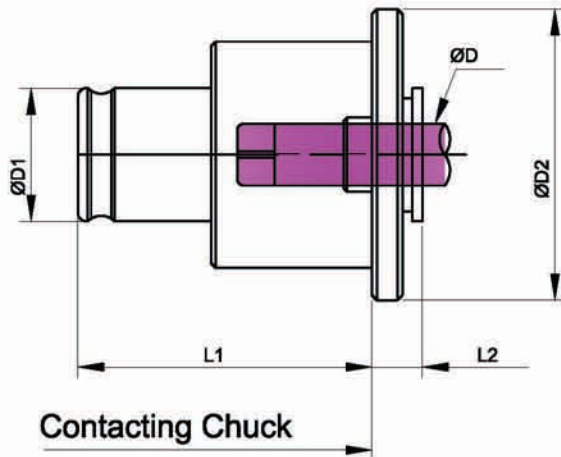

	Range	ØD1	ØD2	L1	L2
TC312B	#06 ~ 9/16"	0.75	1.18	0.85	0.27
TC820B	5/16" ~ 7/8"	1.22	1.89	1.37	0.43
TC1433B	13/16" ~ 1-3/8"	1.89	2.75	1.91	0.55

Tap Collets, Inch Size

Tap Size	Tap Shank				Order No.		
	Shank ØD		Square □		TC312 [#1]	TC820 [#2]	TC1433 [#3]
	Inch	mm	Inch	mm			
#06	0.141	3.581	0.110	2.794	E - 010B - 01		
#08	0.168	4.267	0.131	3.327	E - 010B - 02		
#10	0.194	4.928	0.152	3.861	E - 010B - 03		
#12	0.220	5.588	0.165	4.191	E - 010B - 04		
1/4"	0.255	6.477	0.191	4.851	E - 010B - 05		
5/16"	0.318	8.077	0.238	6.045	E - 010B - 06	E - 020B - 01	
3/8"	0.381	9.677	0.286	7.264	E - 010B - 07	E - 020B - 02	
7/16"	0.323	8.204	0.242	6.147	E - 010B - 08	E - 020B - 03	
1/2"	0.367	9.322	0.275	6.985	E - 010B - 09	E - 020B - 04	
9/16"	0.429	10.897	0.322	8.179	E - 010B - 10	E - 020B - 05	
5/8"	0.480	12.192	0.360	9.144		E - 020B - 06	
11/16"	0.542	13.767	0.406	10.312		E - 020B - 07	
3/4"	0.590	14.986	0.442	11.227		E - 020B - 08	
13/16"	0.652	16.561	0.489	12.421		E - 020B - 09	E - 030B - 01
7/8"	0.697	17.704	0.523	13.284		E - 020B - 10	E - 030B - 02
15/16"	0.760	19.304	0.570	14.478			E - 030B - 03
1"	0.800	20.320	0.600	15.240			E - 030B - 04
1-1/8"	0.896	22.758	0.672	17.069			E - 030B - 05
1-1/4"	1.021	25.933	0.766	19.456			E - 030B - 06
1-3/8"	1.108	28.143	0.831	21.107			E - 030B - 07
PT 1/8"S	0.313	7.938	0.234	5.944	E - 010B - 11		
PT 1/8"L	0.437	11.112	0.328	8.331	E - 010B - 12		
PT 1/4"	0.562	14.287	0.421	10.693		E - 020B - 11	
PT 3/8"	0.700	17.780	0.531	13.487		E - 020B - 12	
PT 1/2"	0.687	17.462	0.515	13.081		E - 020B - 13	E - 030B - 08
PT 3/4"	0.906	23.012	0.679	17.247			E - 030B - 09
PT 1"	1.125	28.575	0.843	21.412			E - 030B - 10