

(with length compensation)

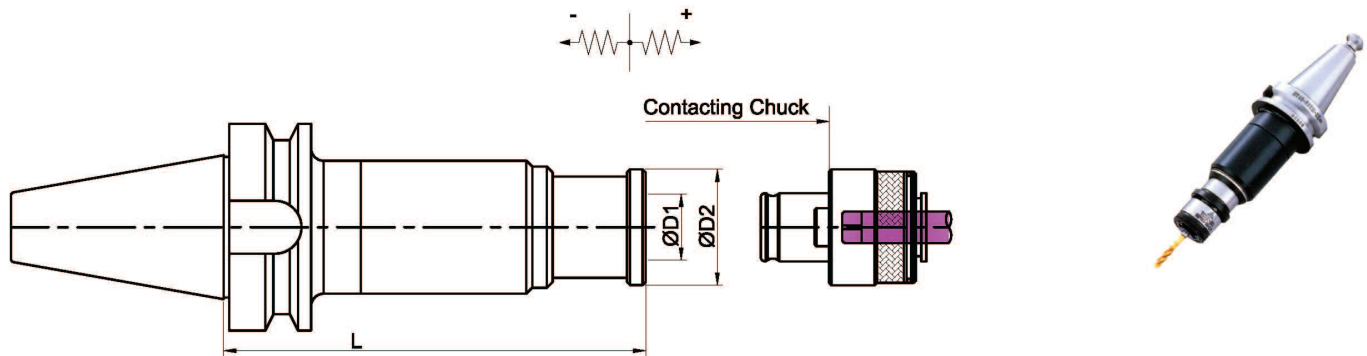

Part No.	Range	L	ØD1	ØD2	Length Comp.		Collets
					Comp.	Tens.	
BT40-WFE12-135	M 3 ~ M12	135	19	46	15.0	20.0	TC 312
-165		165					

BT50-WFE12-135	M 3 ~ M12	135	19	46	15.0	20.0	TC 312
-165		165					
-195		195					

SF Quick Change Tapping Chucks ( rigid type)

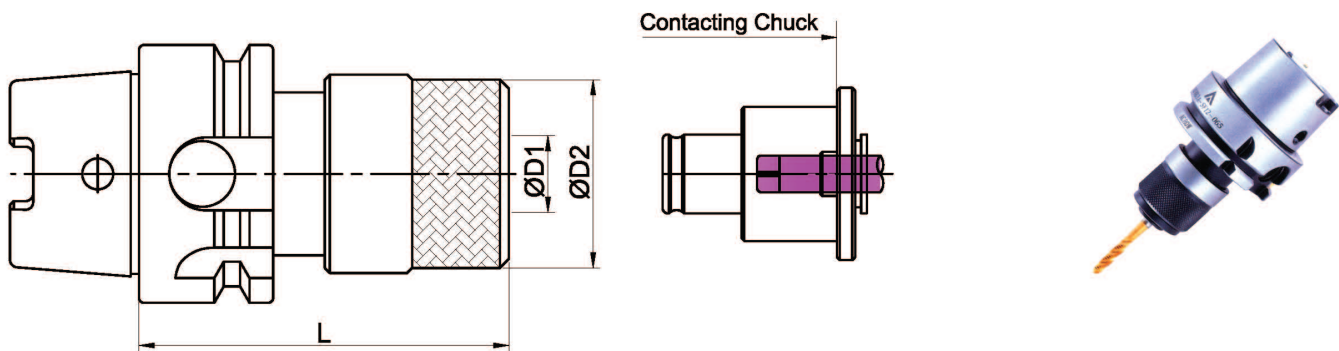

Part No.	Range	L	ØD1	ØD2	Collets
HSK50A-SF12	M 3 ~ M12	65	19	34	TC 312B
-SF20	M 8 ~ M20	98	31	49	TC 820B

HSK63A-SF12	M 3 ~ M12	65	19	34	TC 312B
-SF20	M 8 ~ M20	100	31	49	TC 820B

HSK100A-SF12	M 3 ~ M12	72	19	34	TC 312B
-SF20	M 8 ~ M20	90	31	49	TC 820B
-SF33	M14 ~ M33	126	48	73.5	TC1433B

ACROW IMP

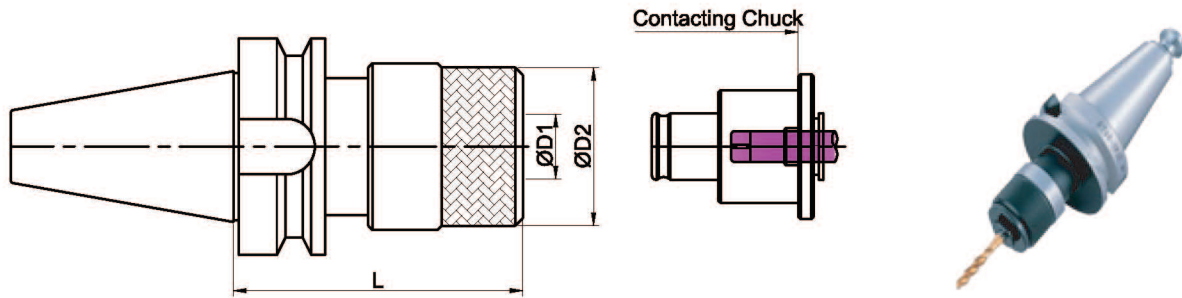

Part No.	Range	L	ØD1	ØD2	Collets
BT30-SF12	M 3 ~ M12	66	19	34	TC 312B
-SF20	M 8 ~ M20	80	31	49	TC 820B

BT40-SF12	M 3 ~ M12	72	19	34	TC 312B
-SF20	M 8 ~ M20	91	31	49	TC 820B
-SF33	M14 ~ M33	130	48	73.5	TC1433B

BT50-SF12	M 3 ~ M12	78	19	34	TC 312B
-SF20	M 8 ~ M20	95	31	49	TC 820B
-SF33	M14 ~ M33	142	48	73.5	TC1433B

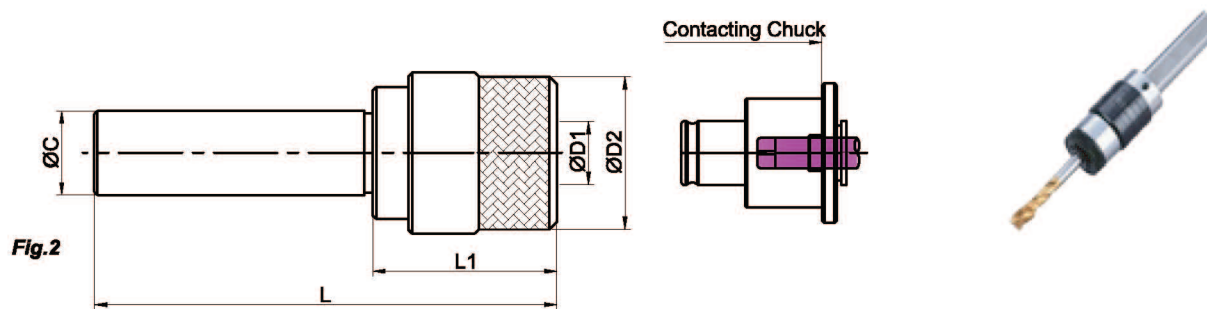
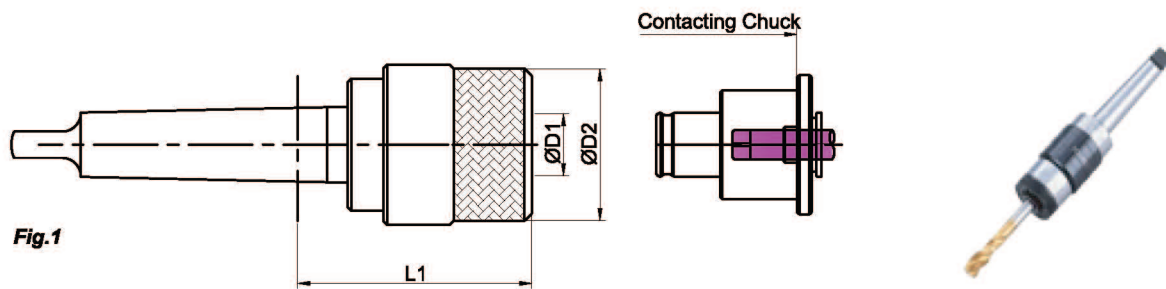

Part No.	Fig.	Range	ØC	L	L1	ØD1	ØD2	Collets
MT2-SF12	1	M 3 ~ M12	-	-	46	19	34	TC 312B
MT3-SF20		70						
MT4-SF20		77			31	49	TC 820B	

ST20-SF12	2	M 3 ~ M12	20	105	40	19	34	TC 312B
-----------	---	-----------	----	-----	----	----	----	---------

\* Tap collets to be ordered separately.